

ONE SOURCE. ONE SOLUTION.



**36" DOUBLE 18 X 8
BUCKET ELEVATOR
PLATFORMS**

ASSEMBLY MANUAL



General Layout	Pg 2
Head Service Platform	Pg 3-14
Work Platform	Pg 15-24
Rest Platform	Pg 25-31

Below is a general platform overview covered in this manual

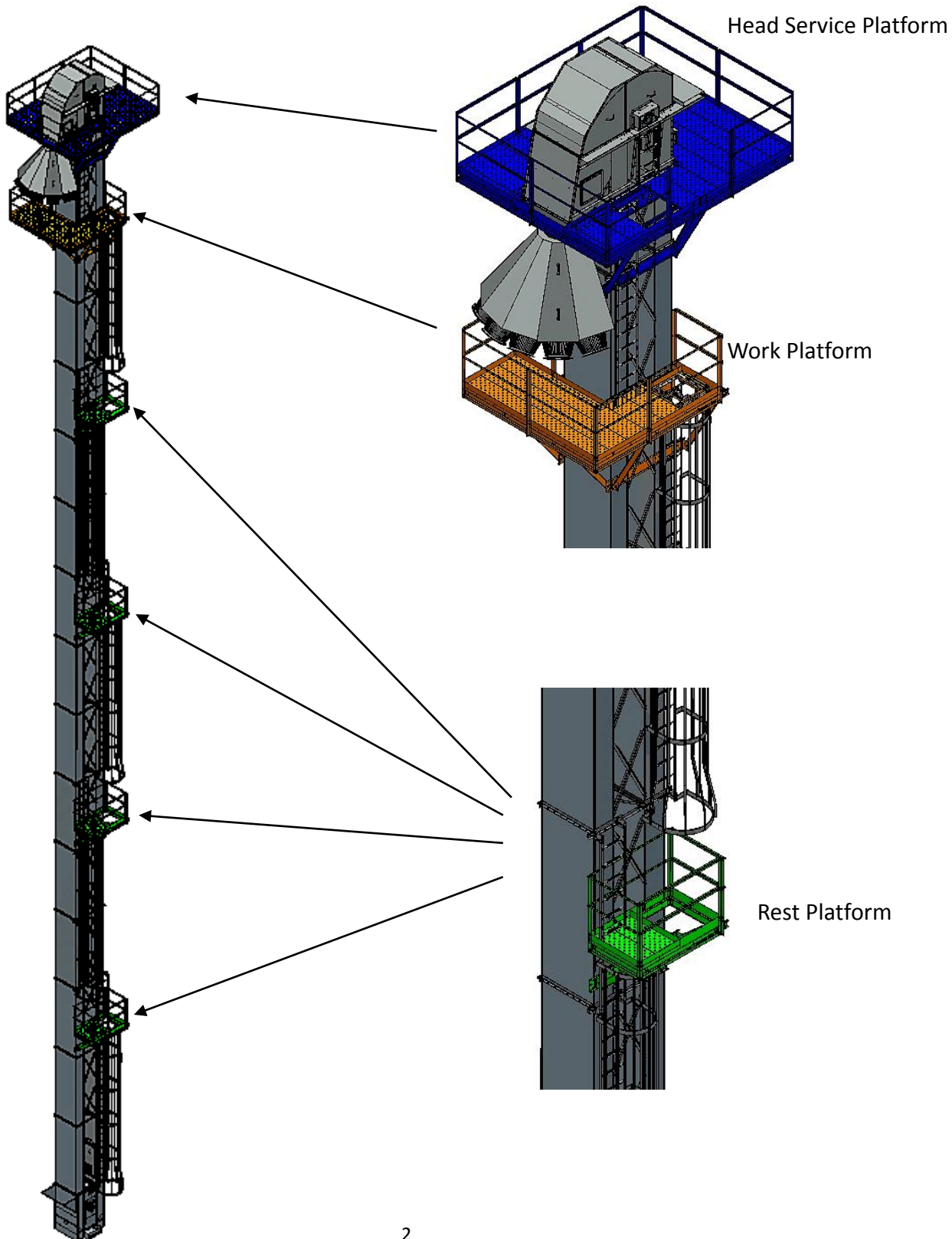

Overview of Head Service Platform

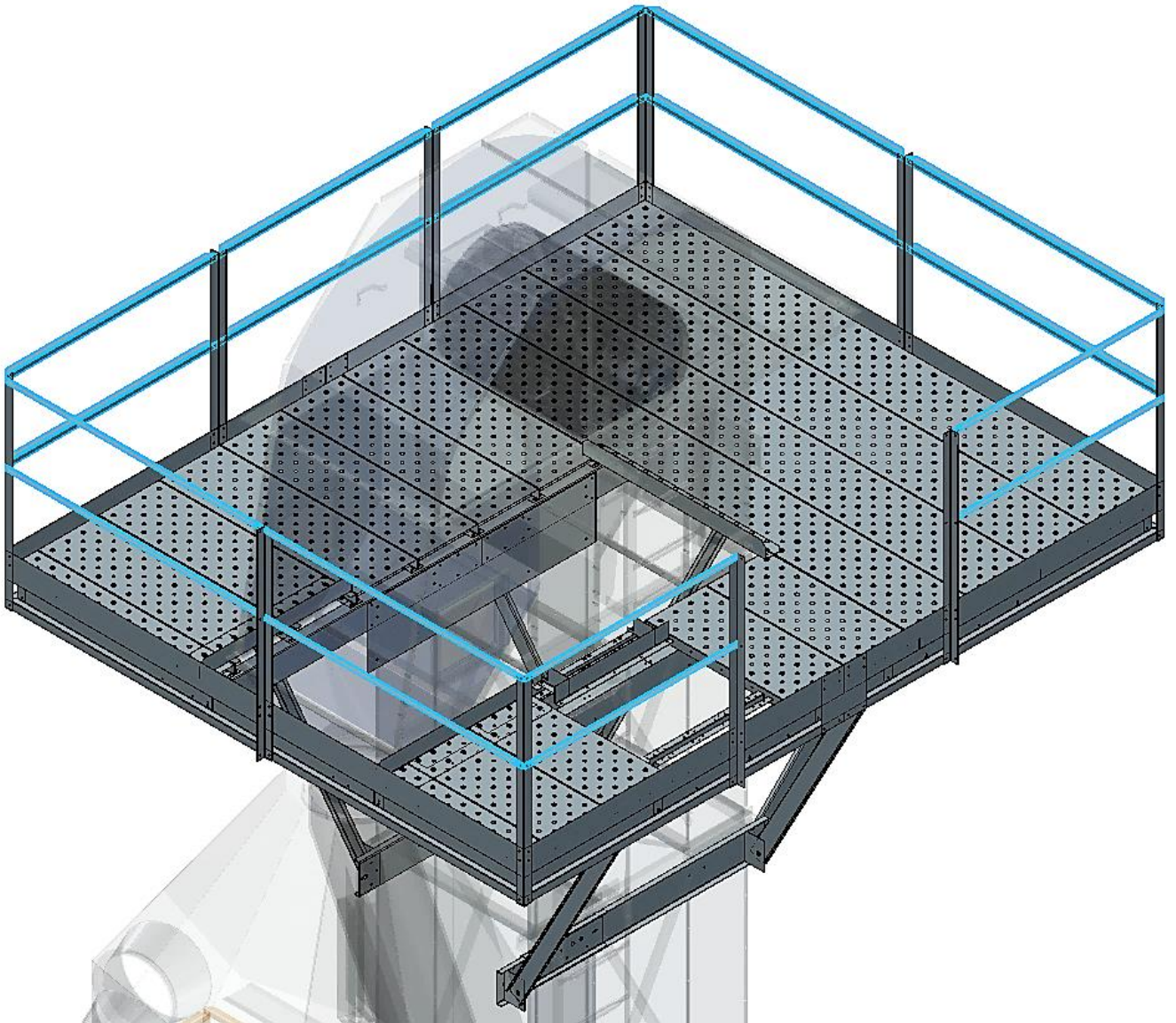

First install the support channels and the anchor channels to the trunking as shown below. The next few pages will show details on locating and fastening these parts.

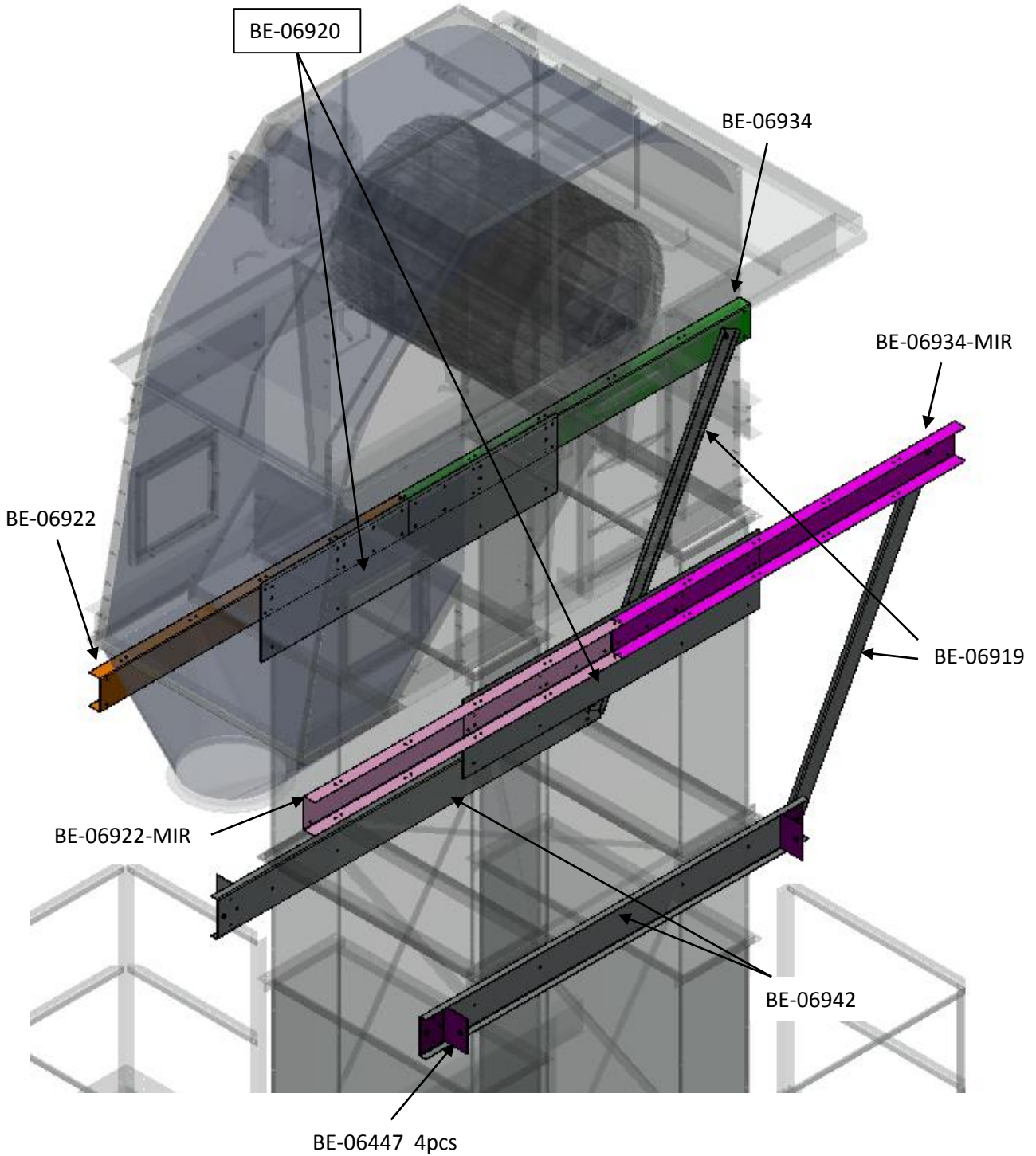

The support channels mount to the trunking with the flat tie plate first and the channel on top as shown below.

Use 3/8" x 1 1/2" Bolt and Nuts

Use 7/8" Bolt, 7/8" Lock Washer, 1" Washer, and 7/8" Hex Nut for kick brace

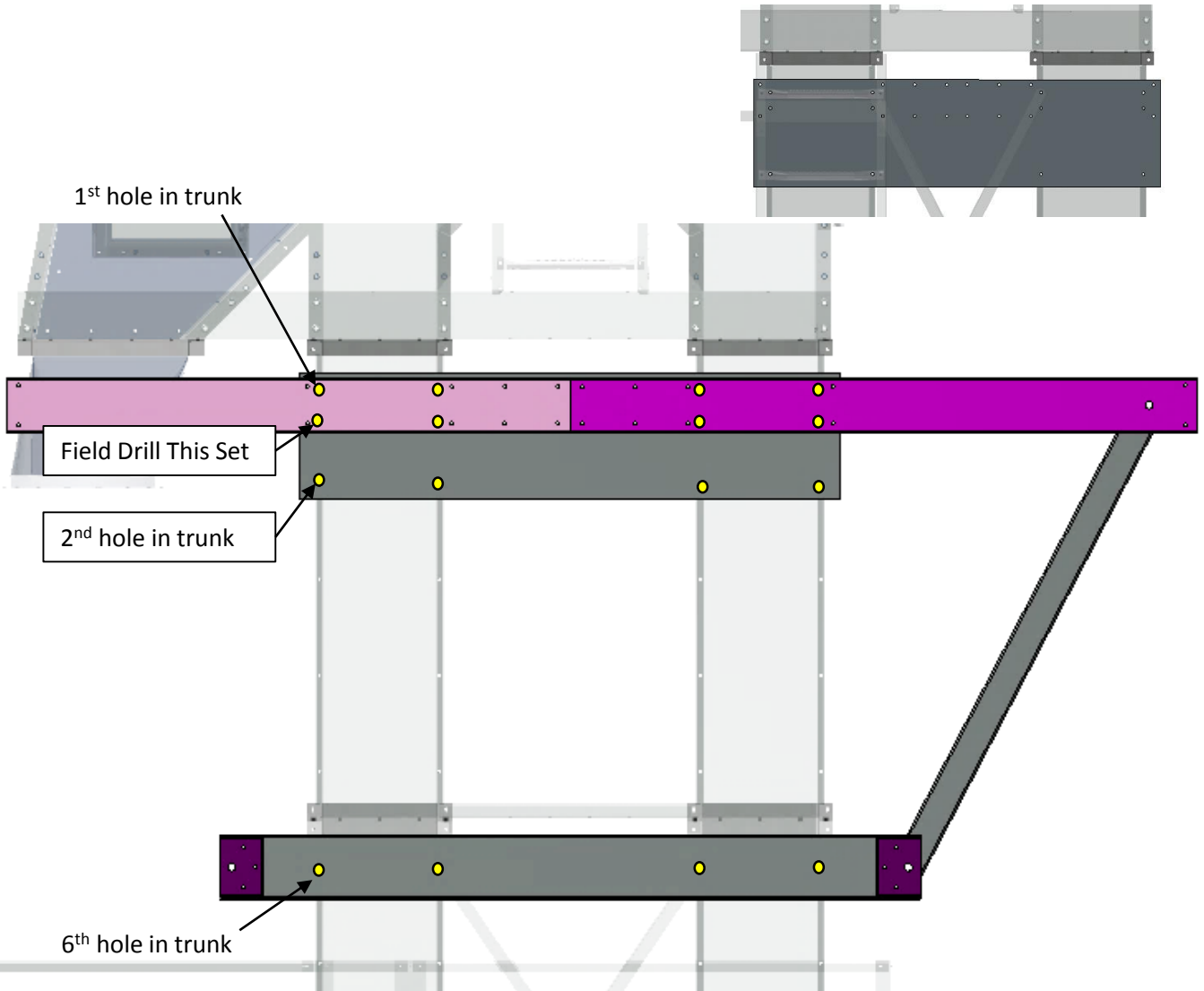

View from far side on next page

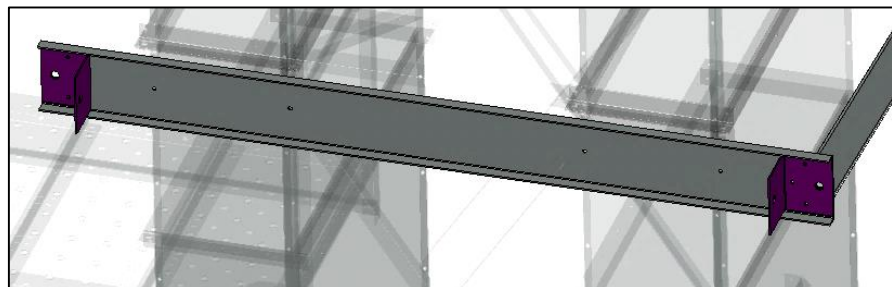

The far side does not use the extension channel and uses 2 kick brace brackets that are the same.

Discharge End

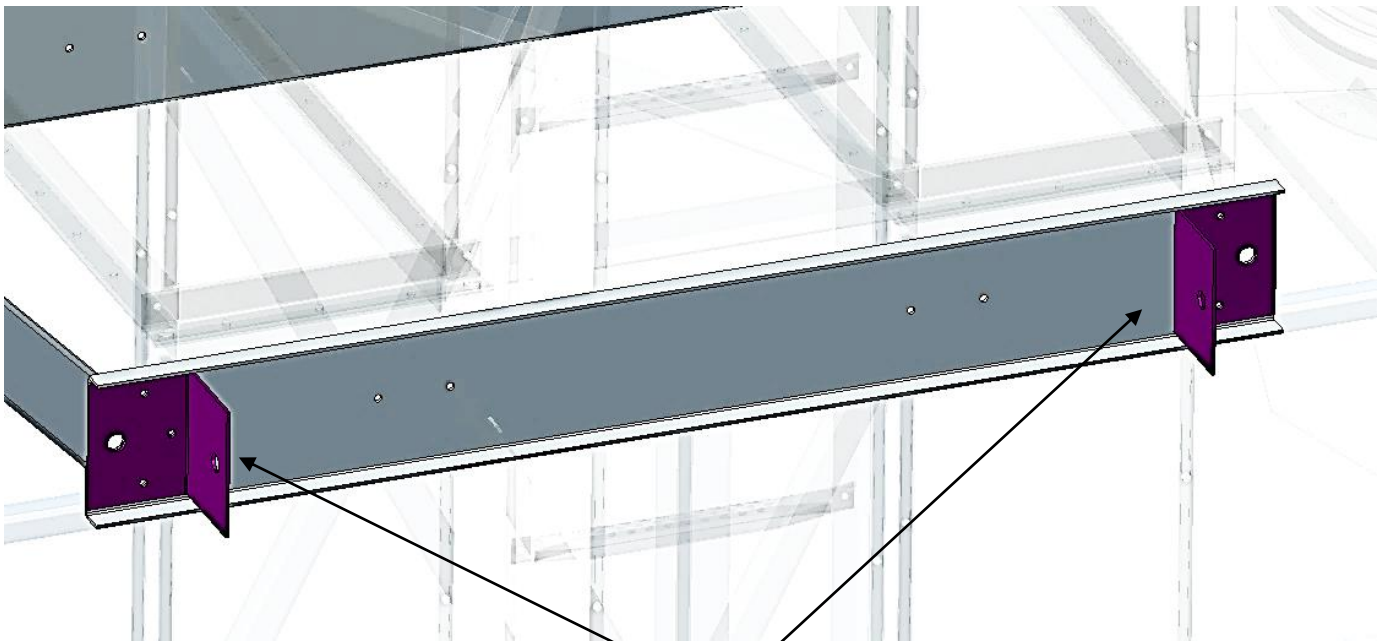

BE-06447

Install the toe board channels along with attachment brackets and corner clips.
Use 5/16" x 3/4" Bolt and Nuts

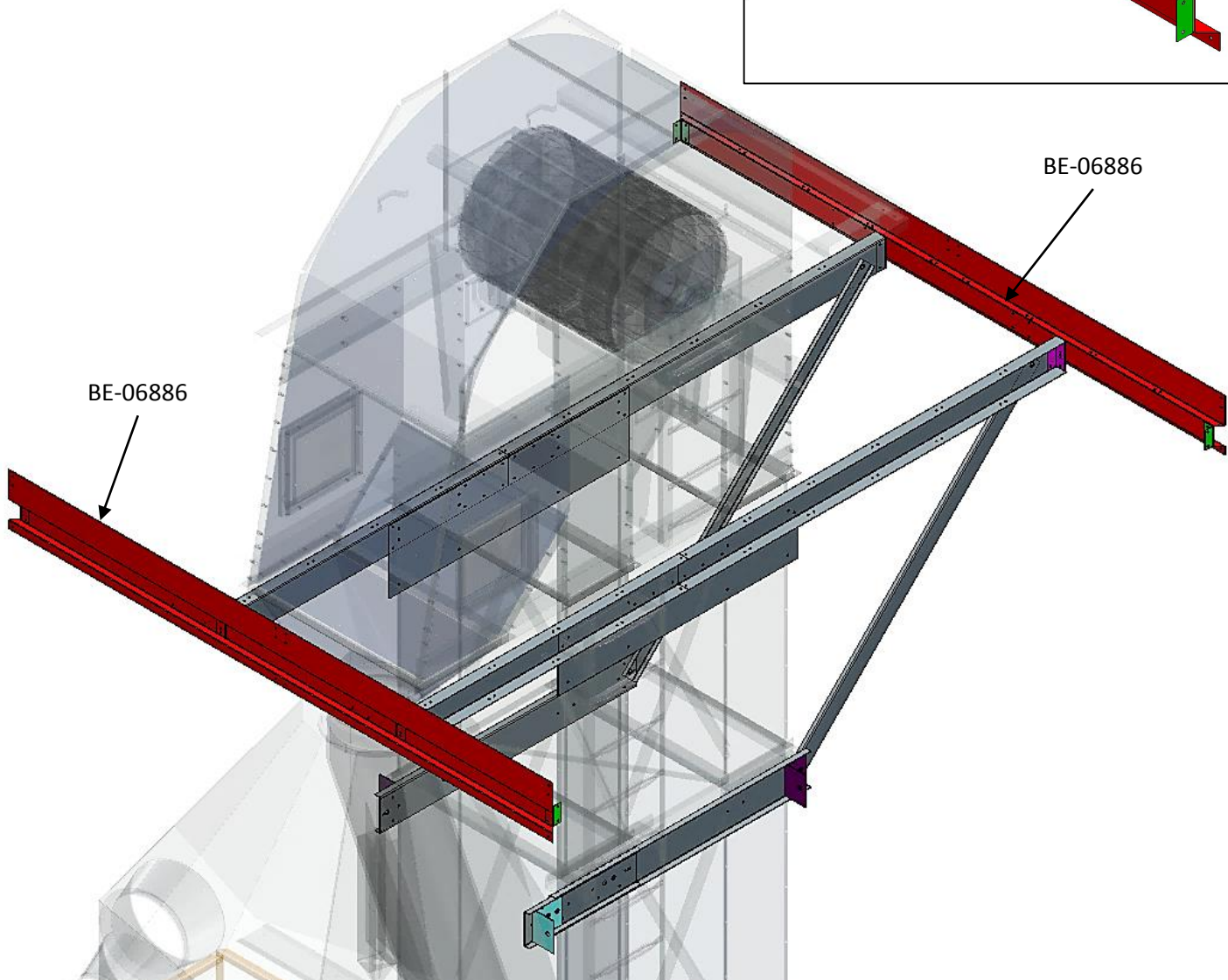
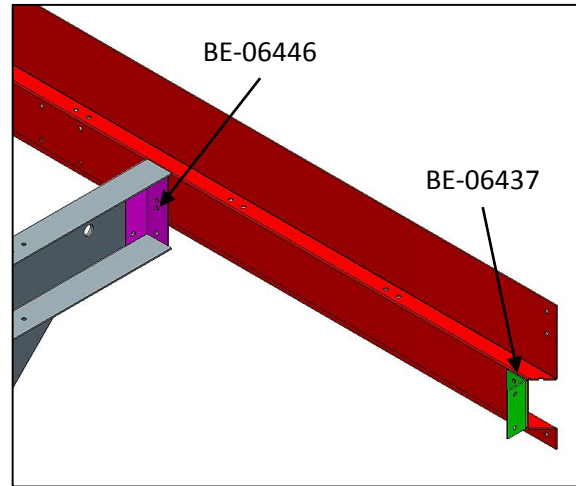

Next install the remaining toe board channels along with kick braces. Between the toe board channel joints there are splice plates in and outside.

Use 5/16" x 3/4" Bolts and Nuts

Use 7/8" Bolt, 7/8" Lock Washer, 1" Washer, and 7/8" Hex Nut for kick brace

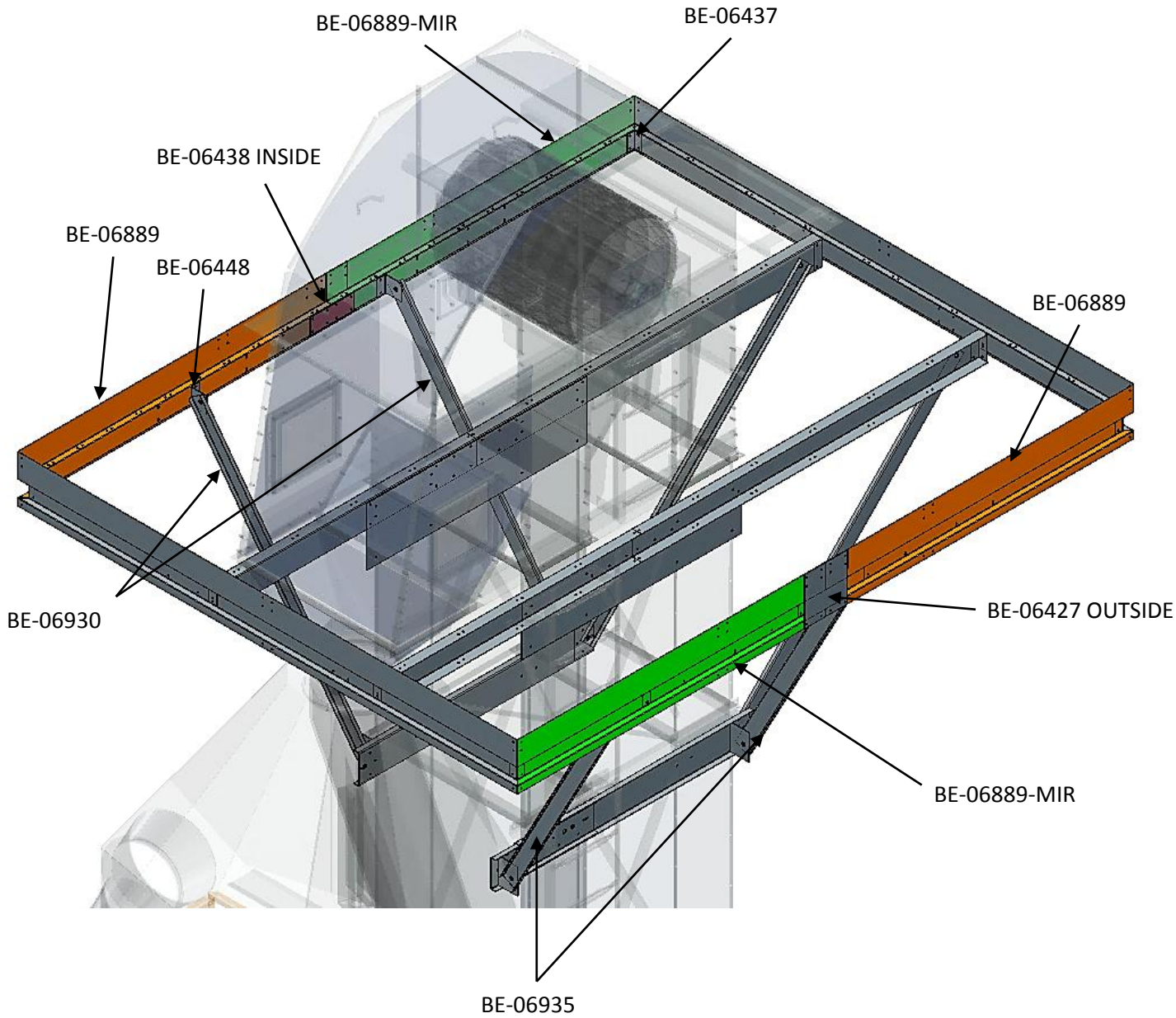

Next install the floor planks and door panel. The planks will mount to the top flange of the channels as shown below. Also fasten all the planks to each other through the horizontal holes in the plank channel.

Use 5/16" x 3/4" Bolt and Nuts

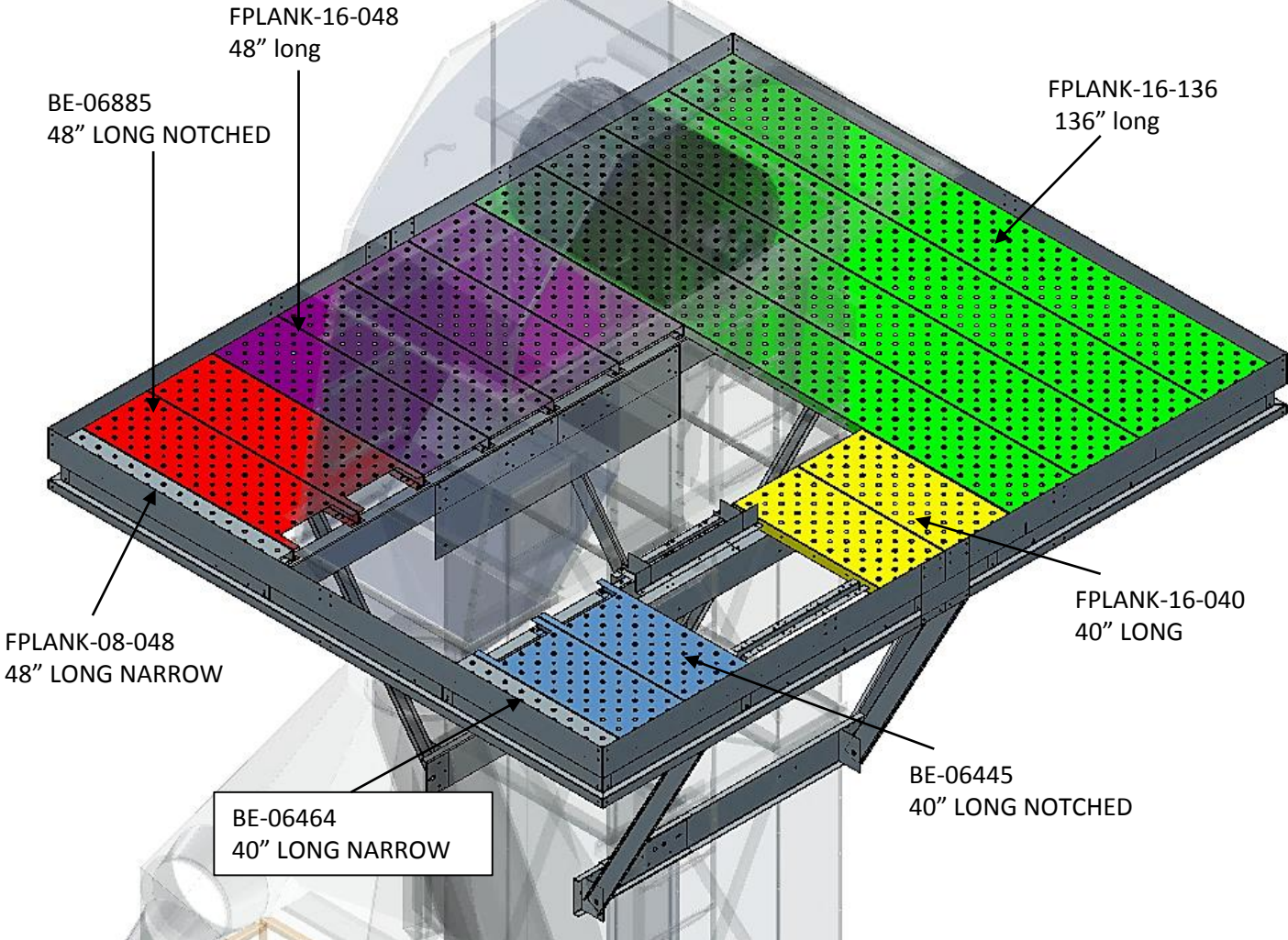

Bolt Planks Together

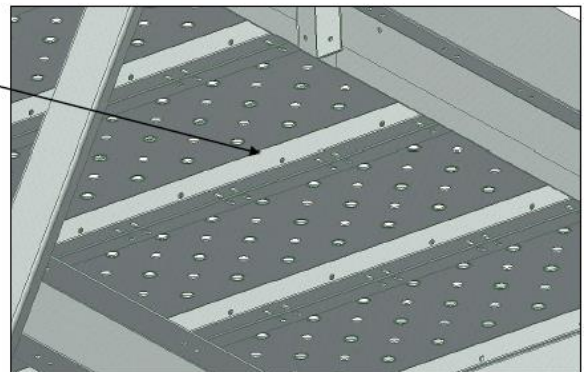

VIEW FROM BOTTOM

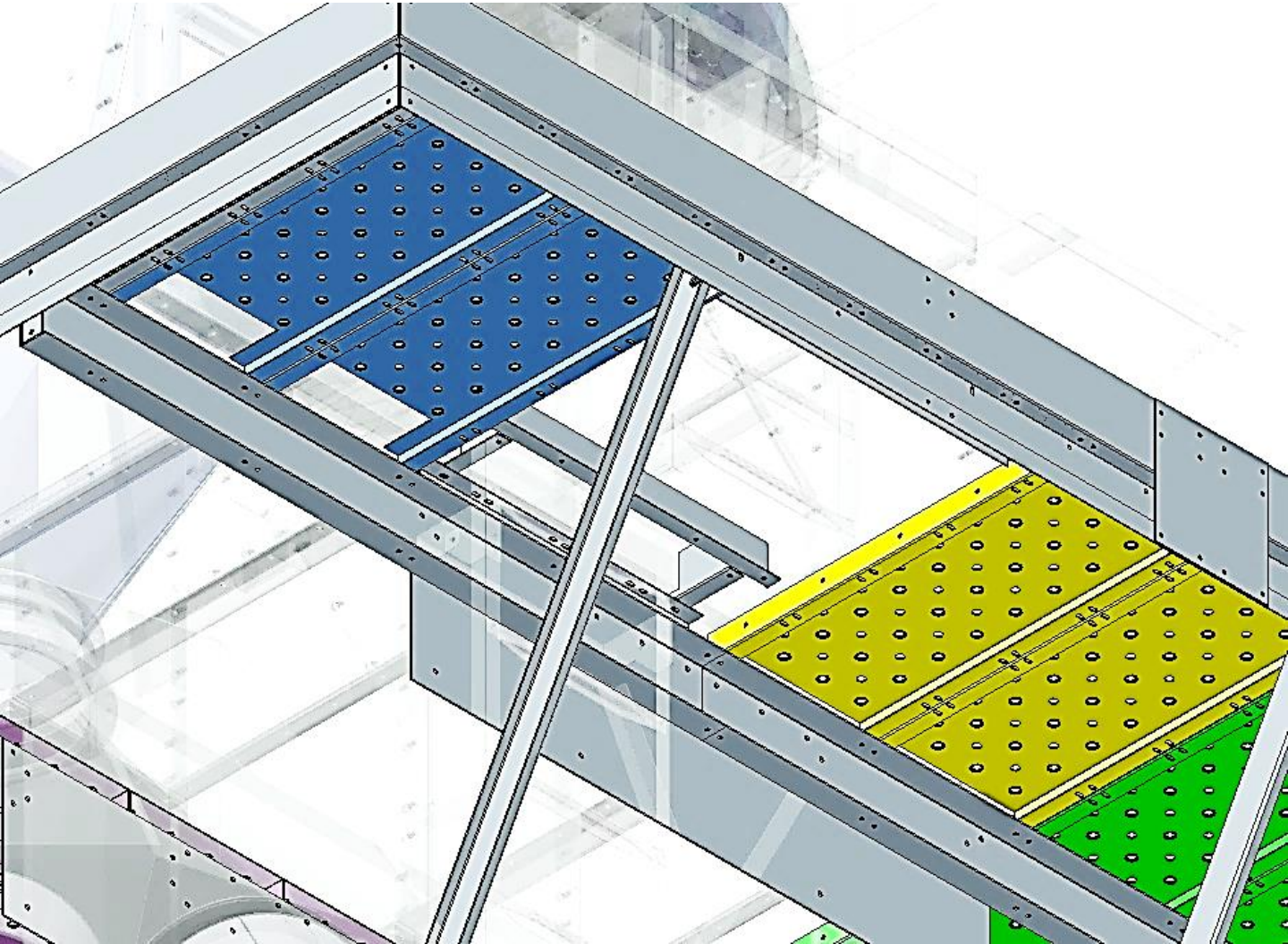

Install the door section similar to the floor planks as shown below

Install toe boards to
Door section
Use 5/16" x 3/4" Truss bolts

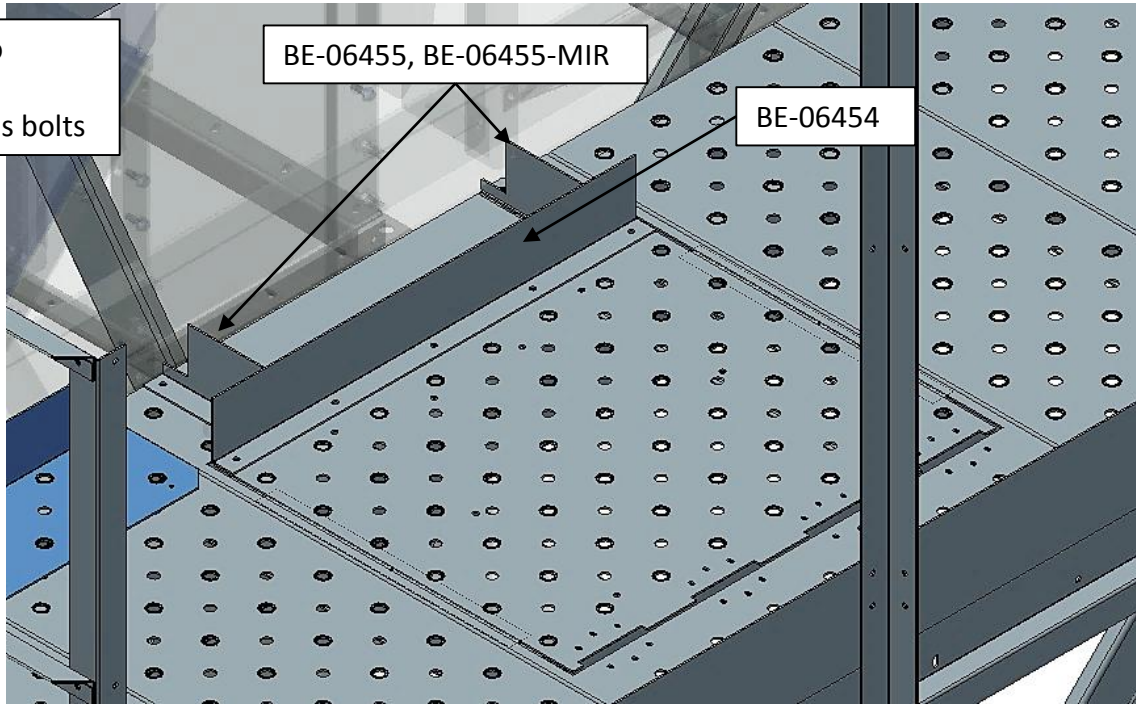

View from Bottom

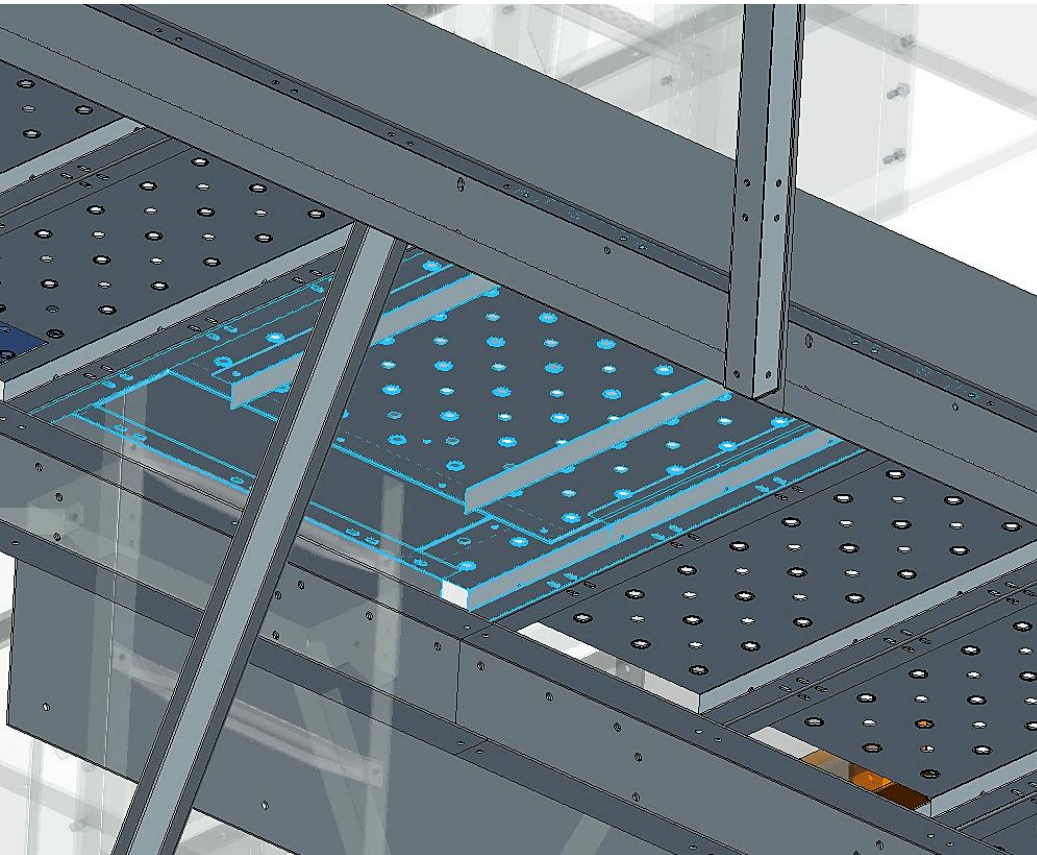

Install toe boards to platform as shown below
Use 5/16" x 3/4" Self Drilling Screws

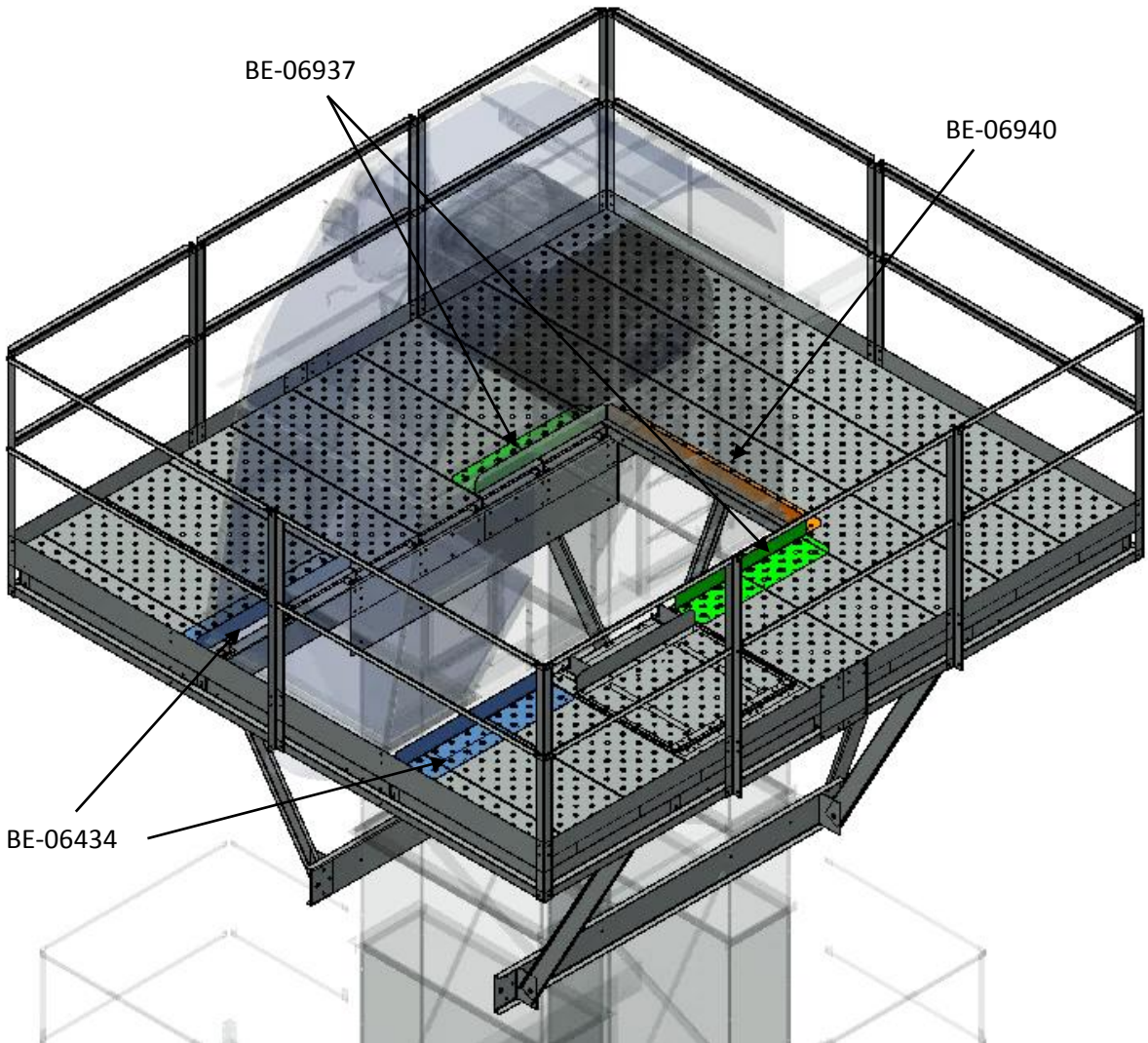

Install the handrail post around the perimeter channels as shown
Use 5/16" x 3/4" Bolts and Nuts

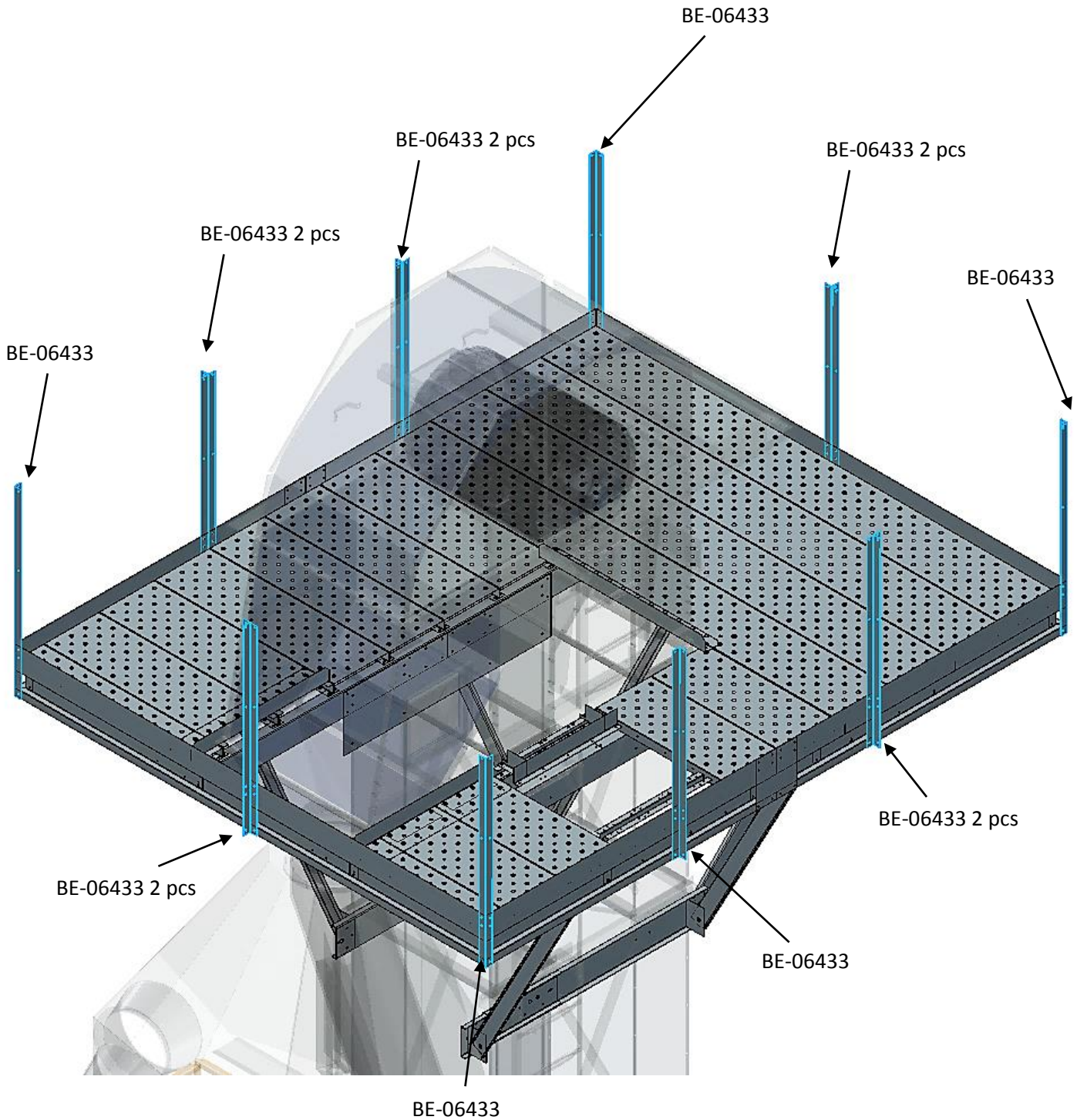

Next install the handrails to the rail posts
Use 5/16" x 3/4" Bolt and Nuts

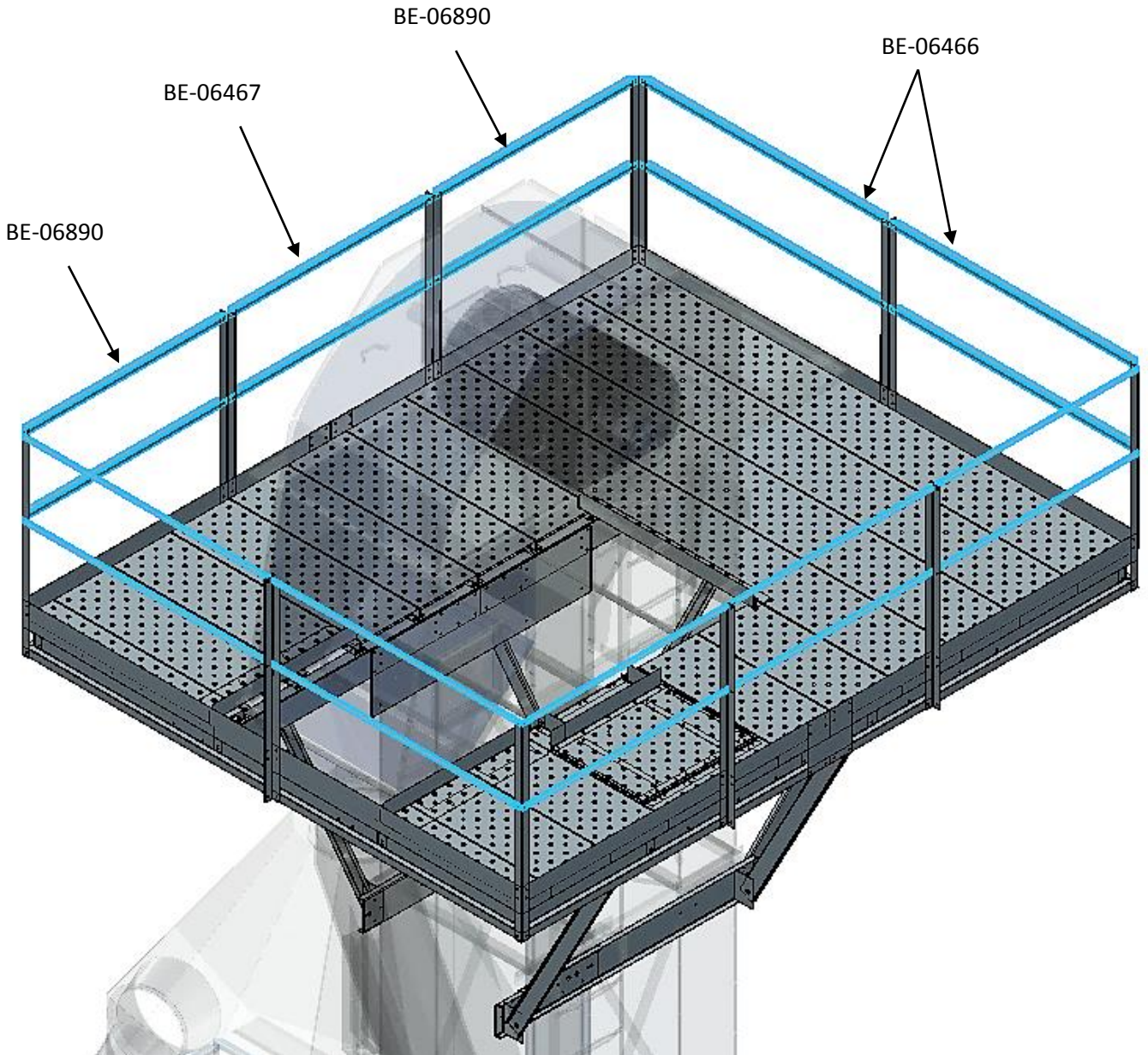

Below is a General Overview of the Work Platform

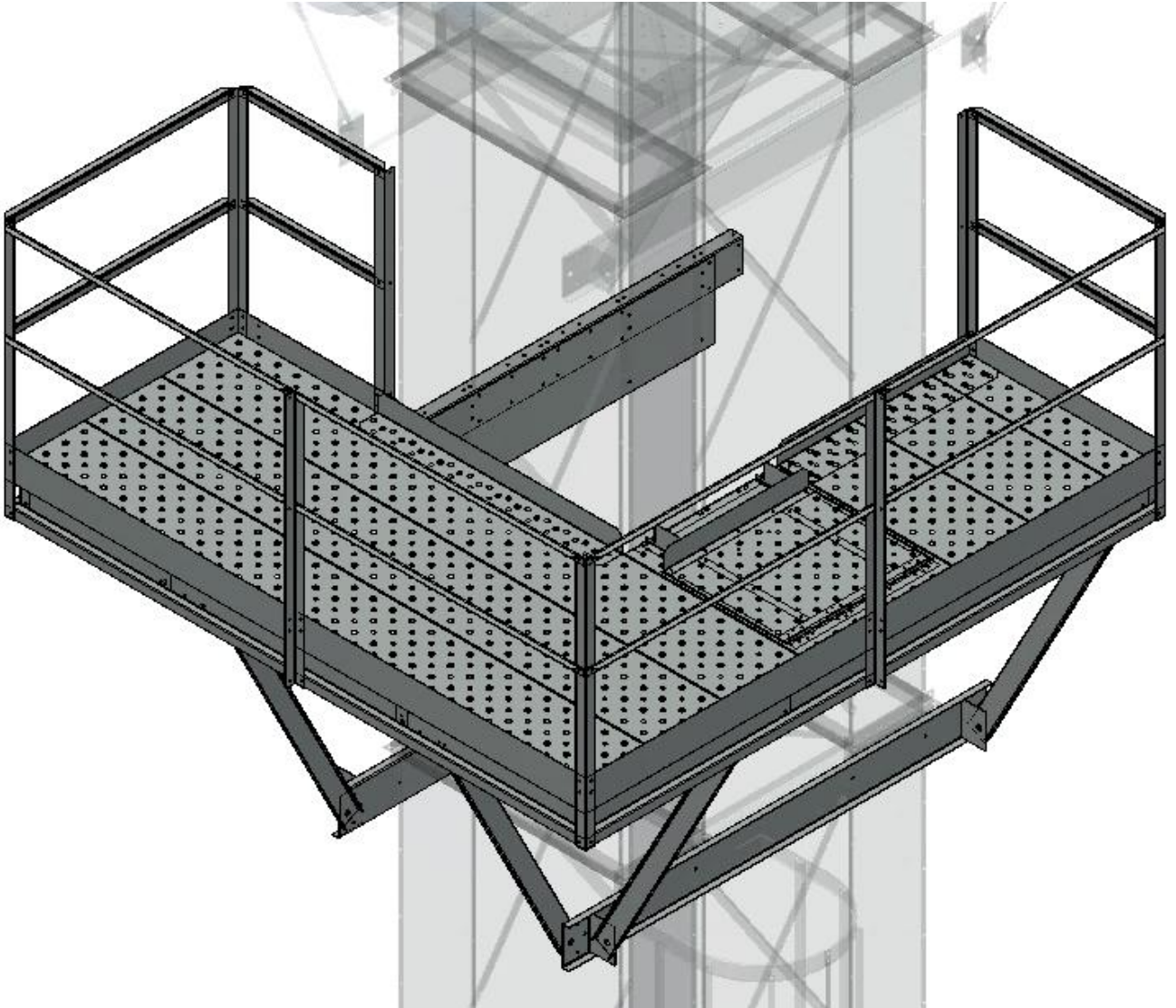

Install the support channels and anchor channels as shown below.
Details will be shown on the next few pages
Use 3/8" x 1 1/2" Bolts and Nuts

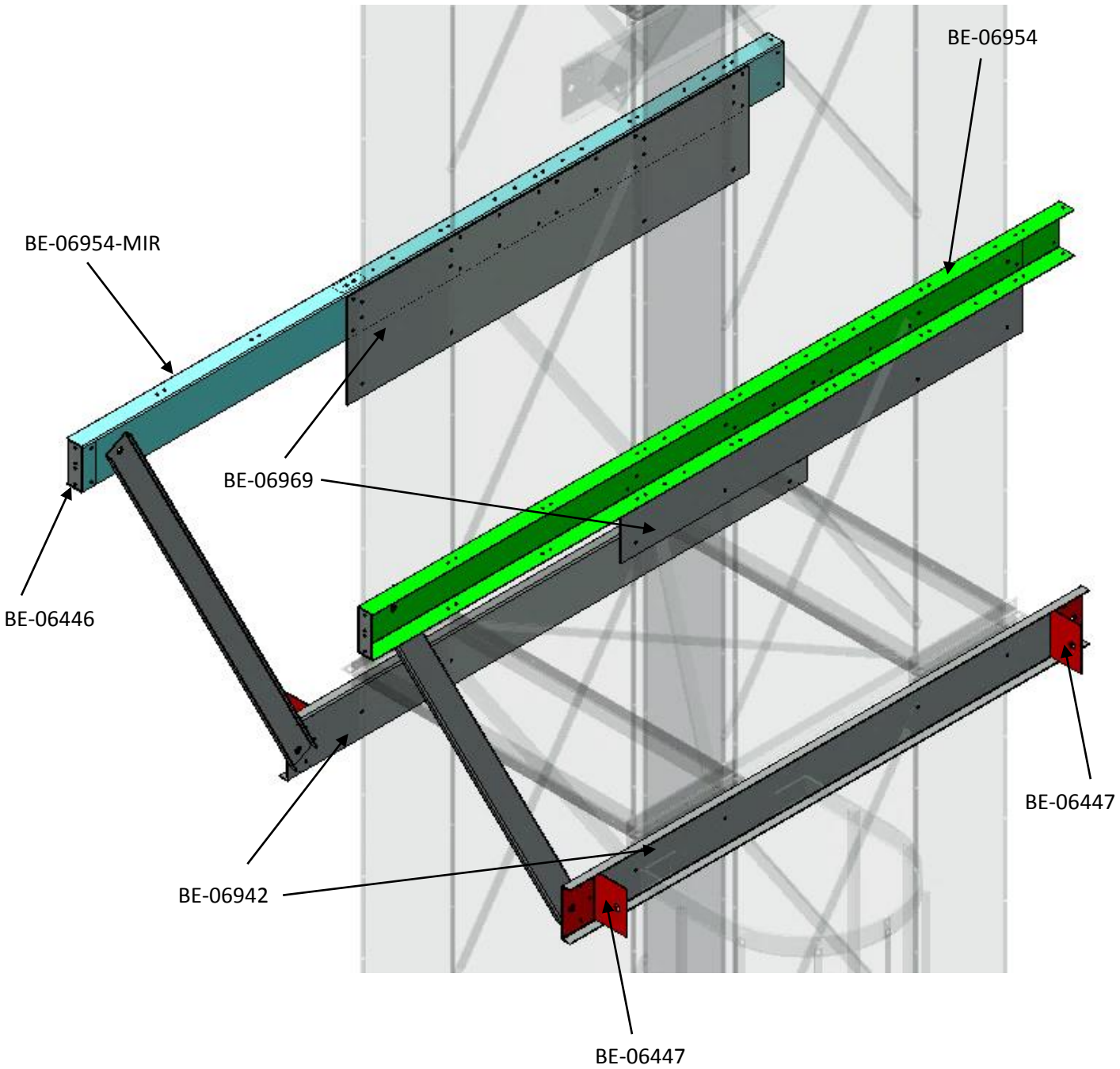

Install the support channels and anchor channels as shown below.
Details will be shown on the next few pages
Use 3/8" x 1 1/2" Bolts and Nuts

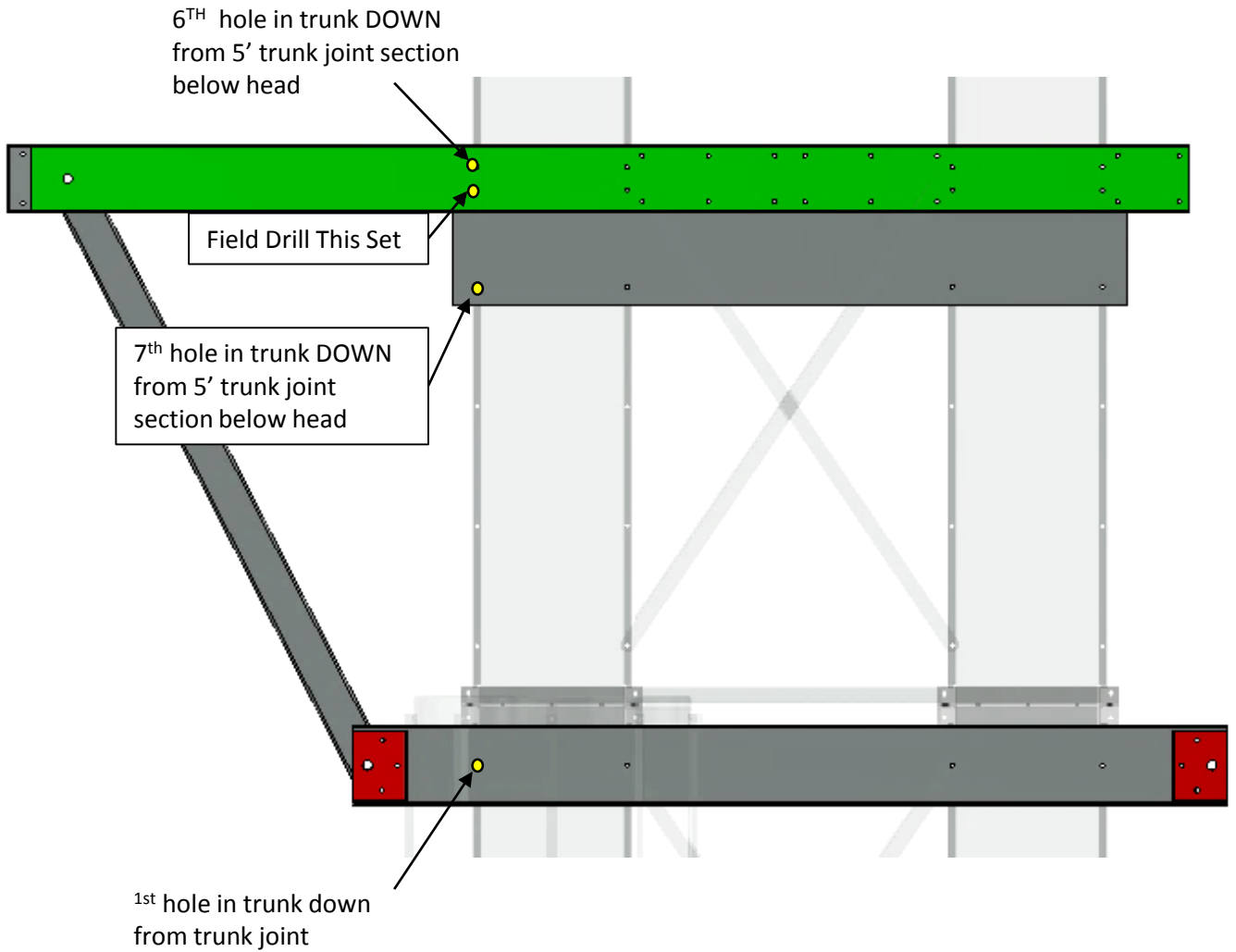

Next install the toeboard channels to the support channels as shown below. Along with the kick braces.
Use 5/16" x 3/4" Bolts and Nuts
Use 7/8" Bolt, 7/8" Lock Washer, 1" Washer, and 7/8" Hex Nut for kick brace

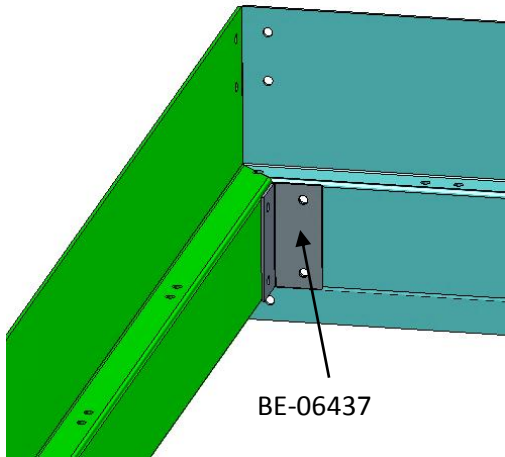

BE-06437

BE-06967

View A

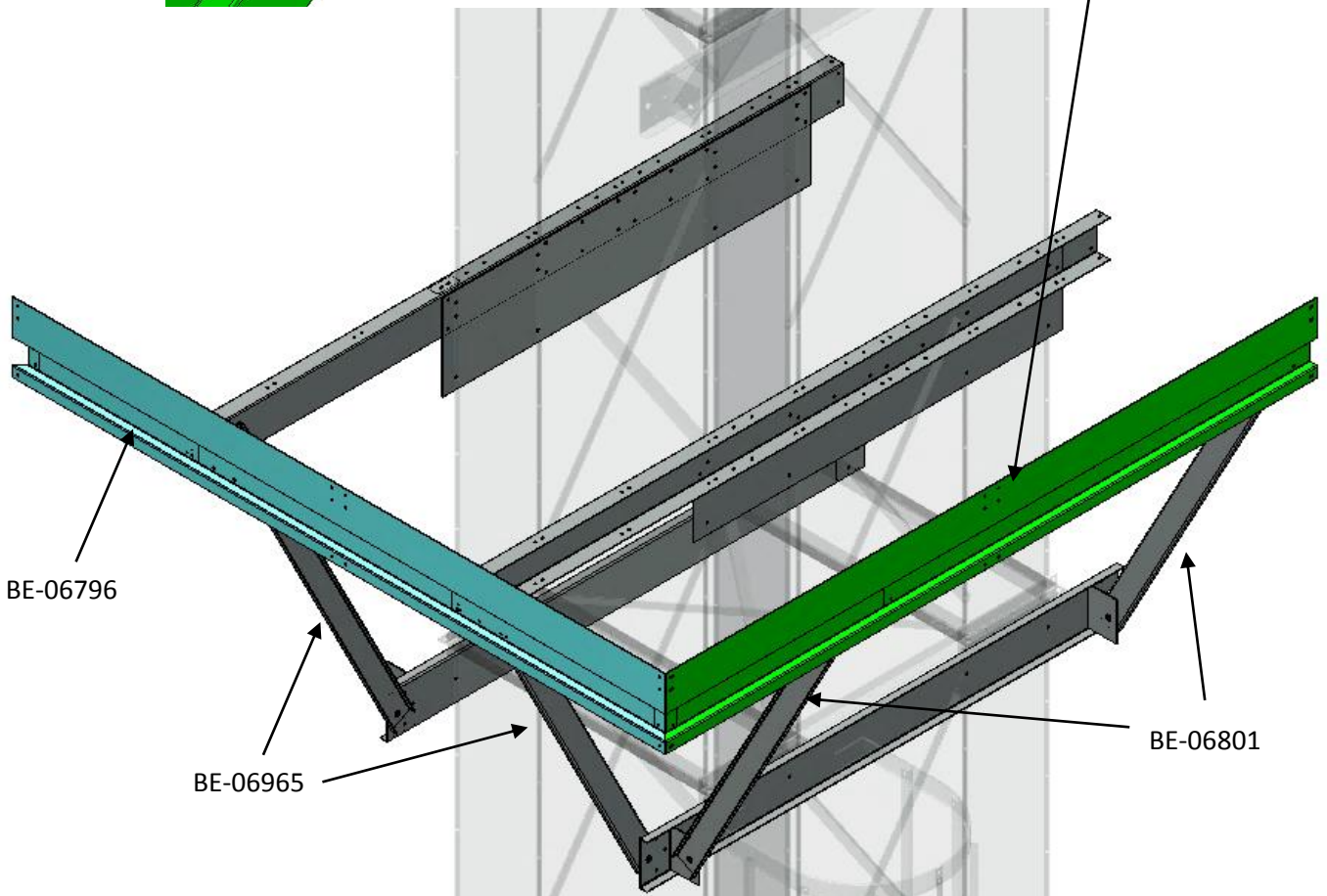

BE-06796

BE-06965

BE-06801

View A

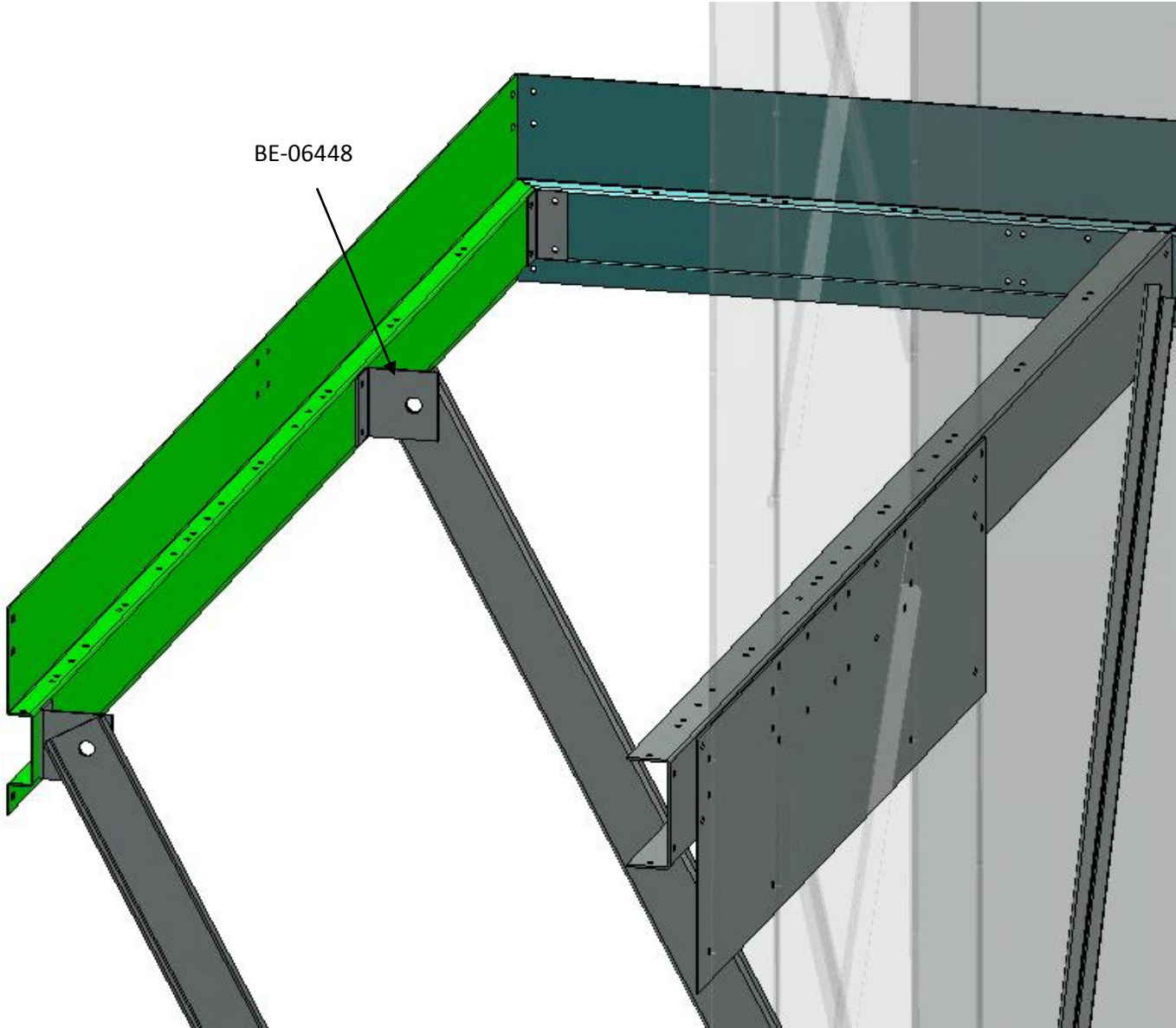

Next install the floor planks and door panel. The planks will mount to the top flange of the channels as shown below. Also fasten all the planks to each other through the horizontal holes in the plank channel.

Use 5/16" x 3/4" Bolt and Nuts

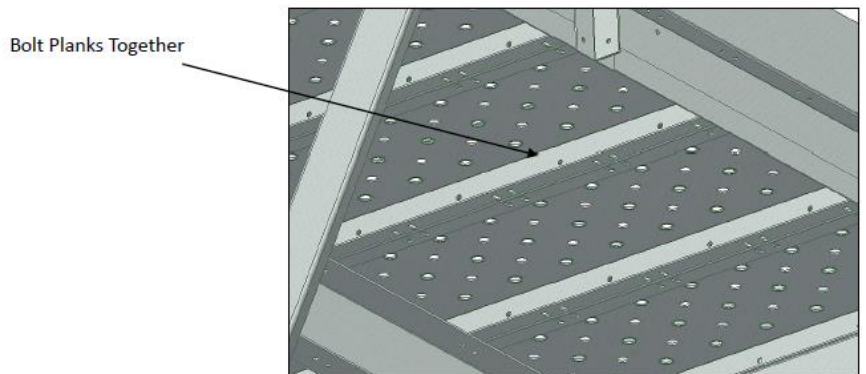
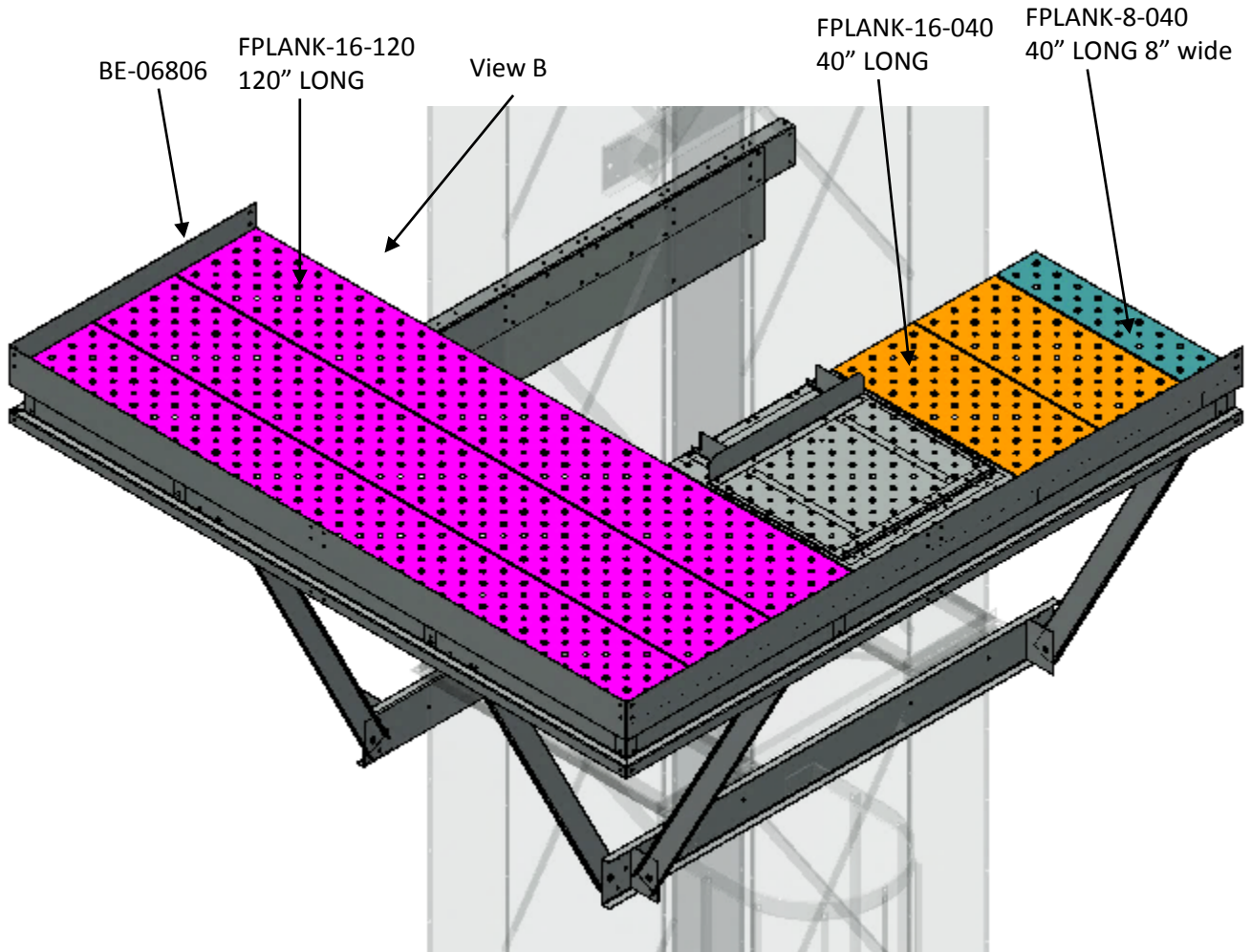

On the underside there is 2 retaining Z clips to tie the floor planks down
Use 5/16" x 3/4" Bolt and Nuts

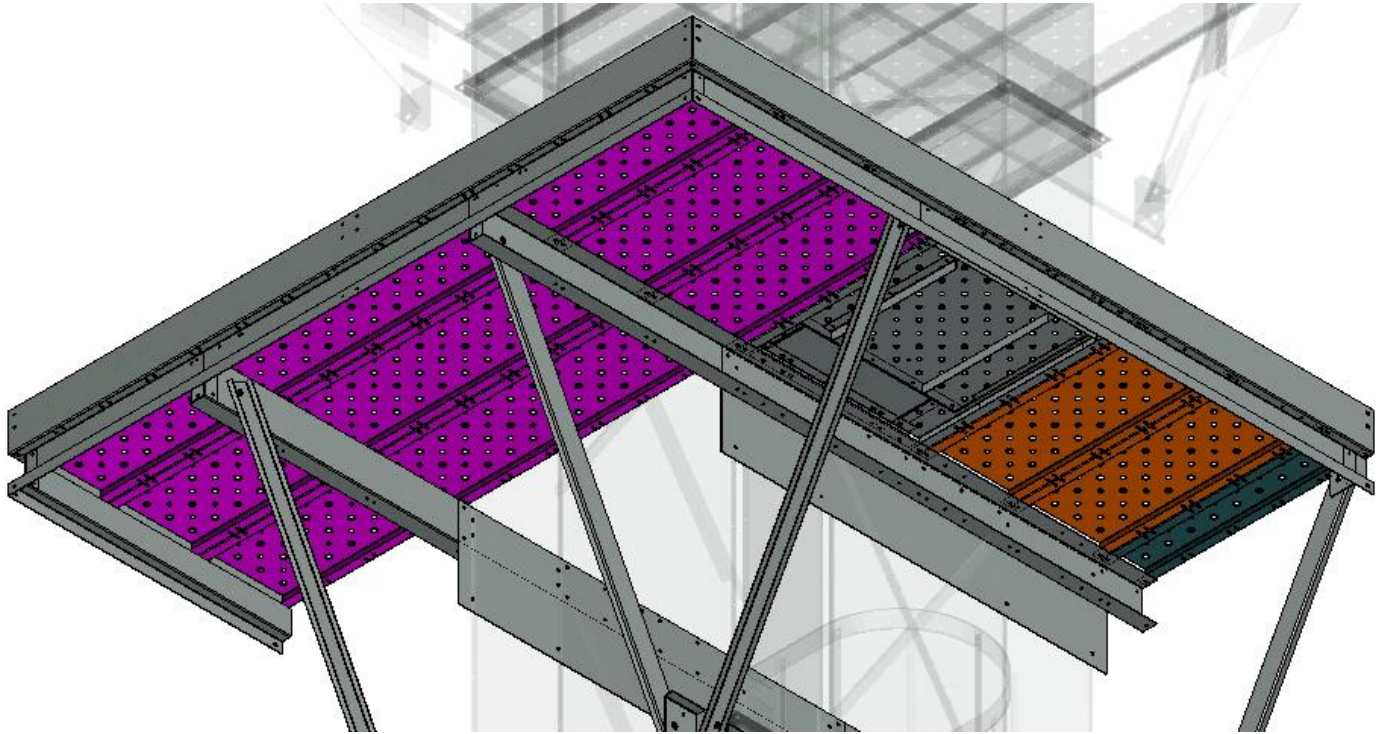

View B

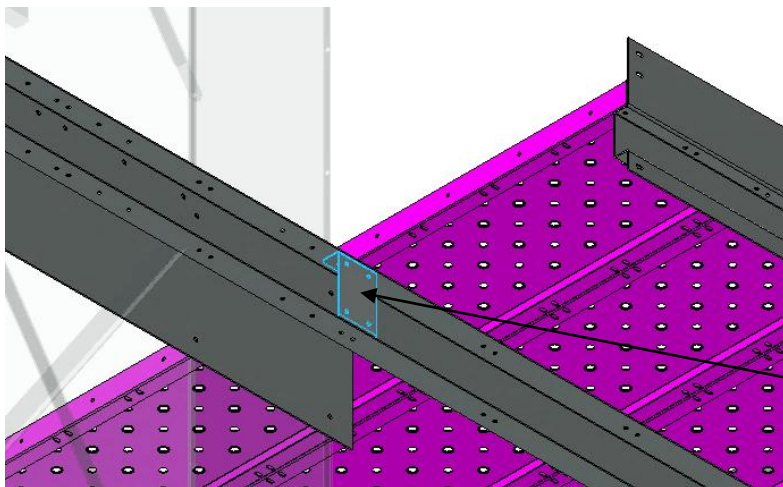

BE-06813 Rail post bracket

Next install the toeboards and door section as shown below

Use 5/16" x 3/4" Truss Bolt and Nuts for toe boards

Use 5/16" x 3/4" Bolts and Nuts for door section

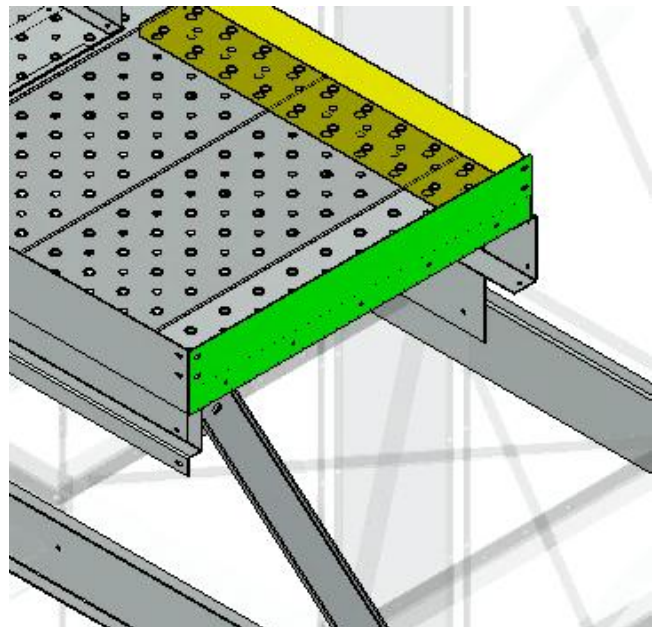
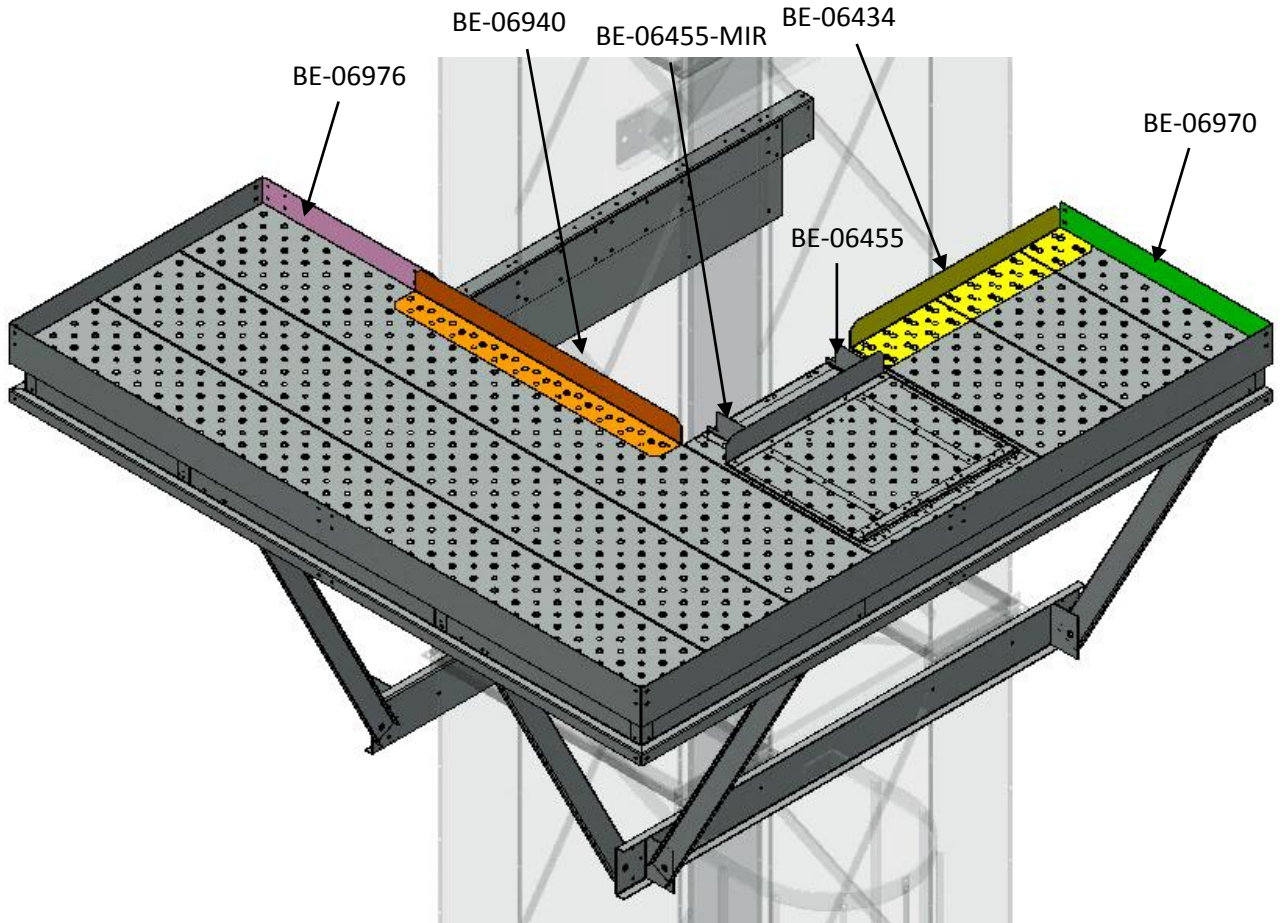

Install rail post to perimeter of work platform
Use 5/16" x 3/4" Bolts and Nuts

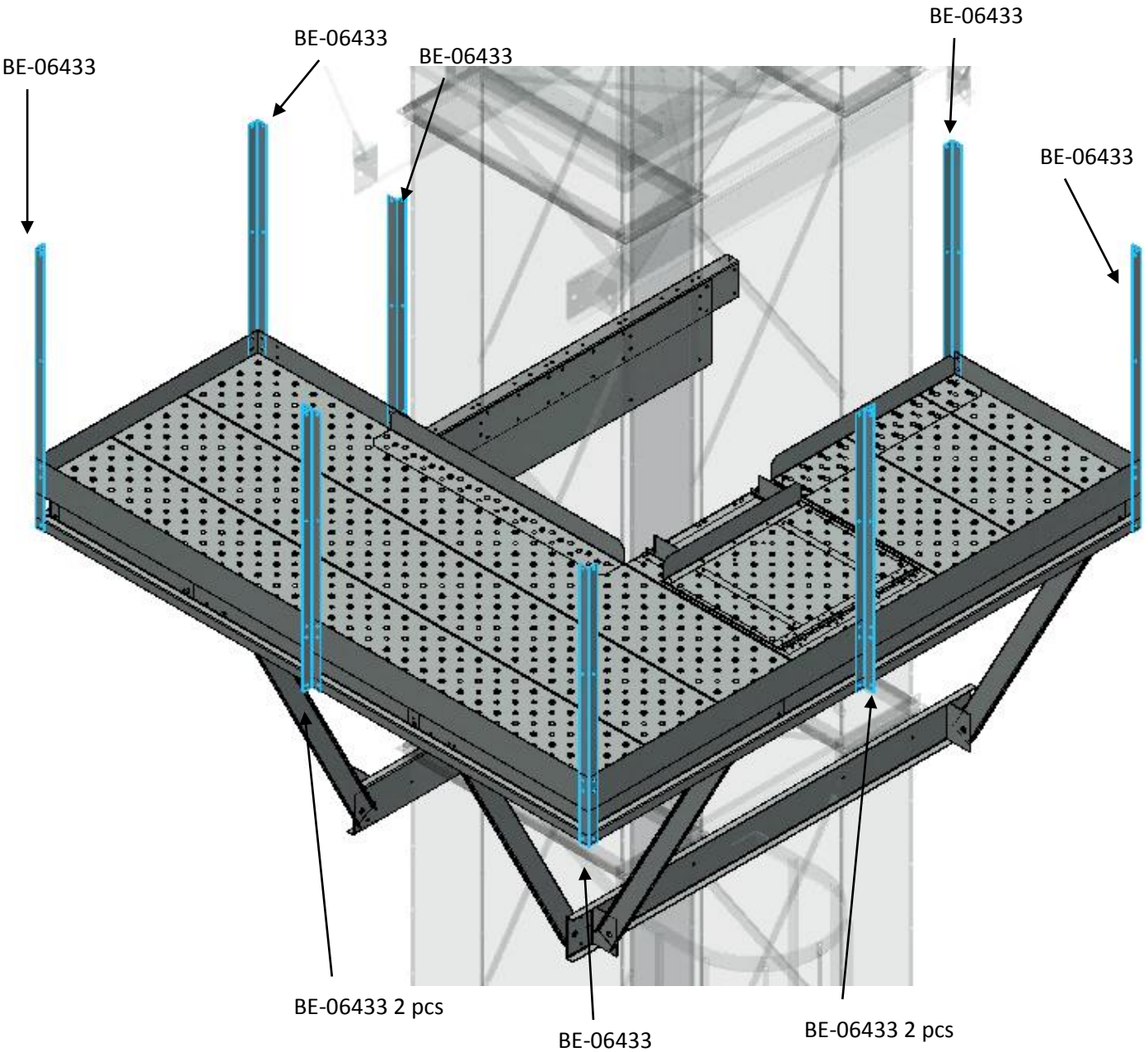

Install the handrails as shown below
Use 5/16" x 3/4" Bolt and nuts

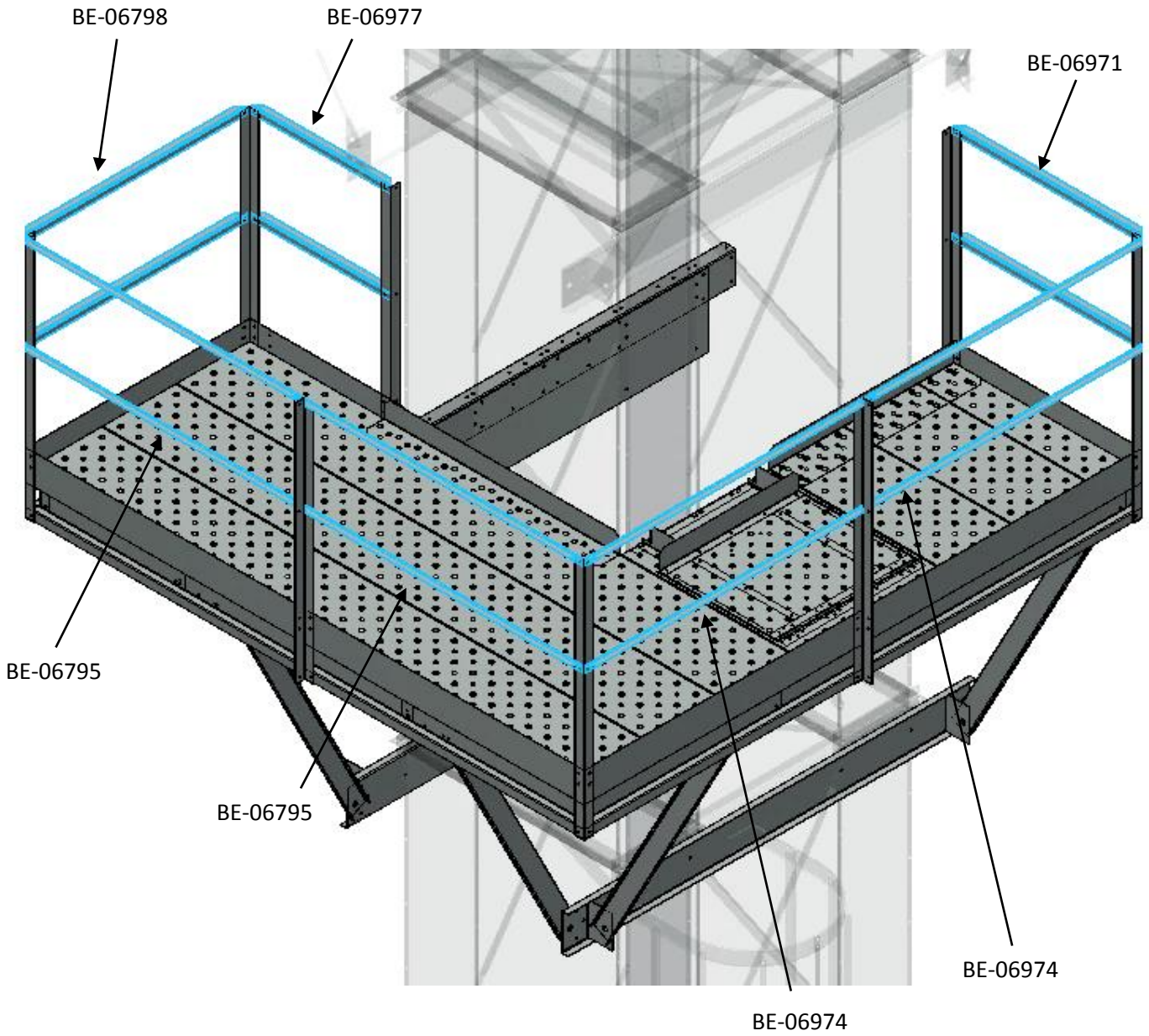

General Overview of Rest Platform

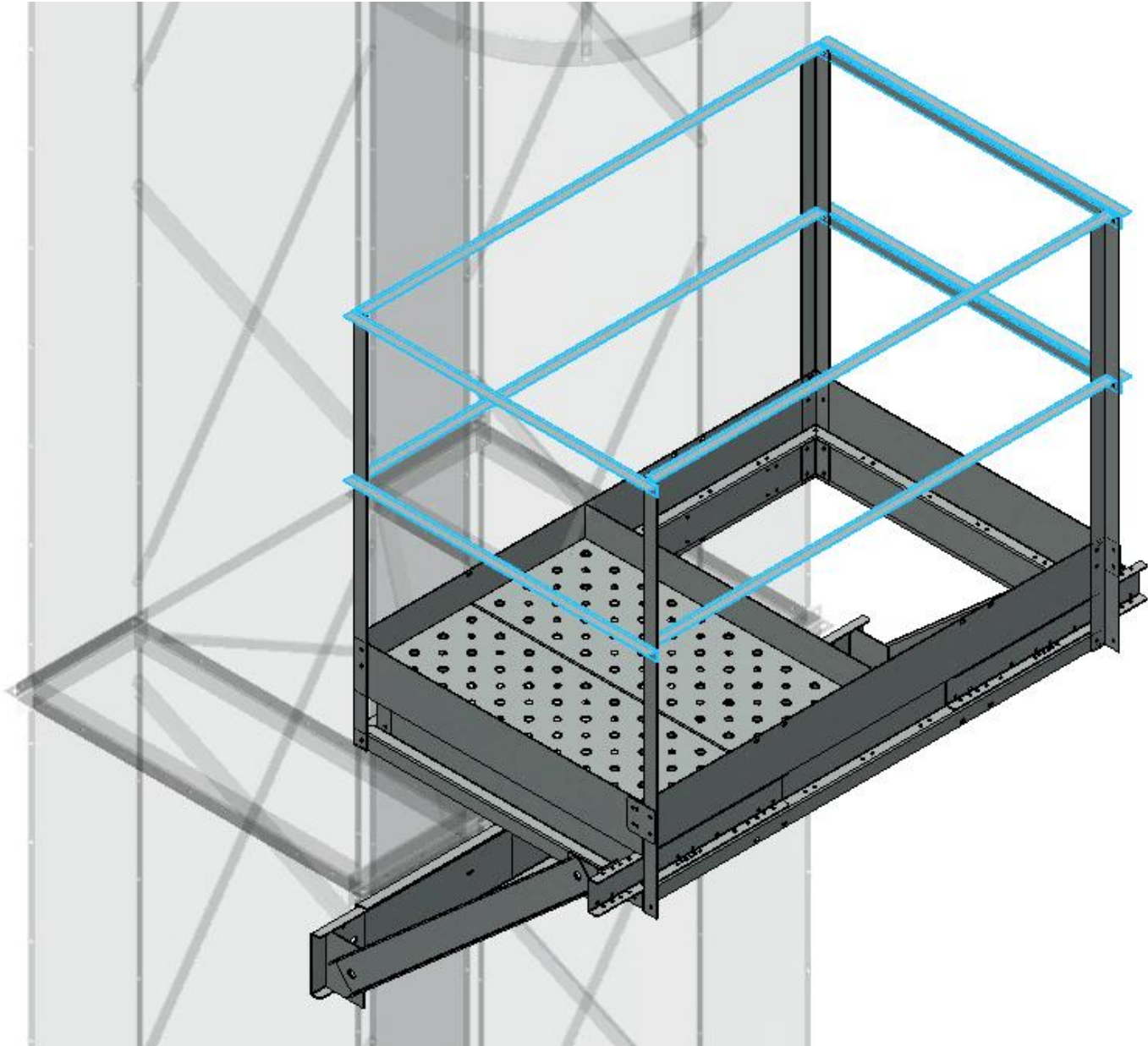

Install one of the toe board channels and anchor channel to the trunks as shown. Details shown on next few pages
Use 3/8" x 1 1/2" Bolts and Nuts

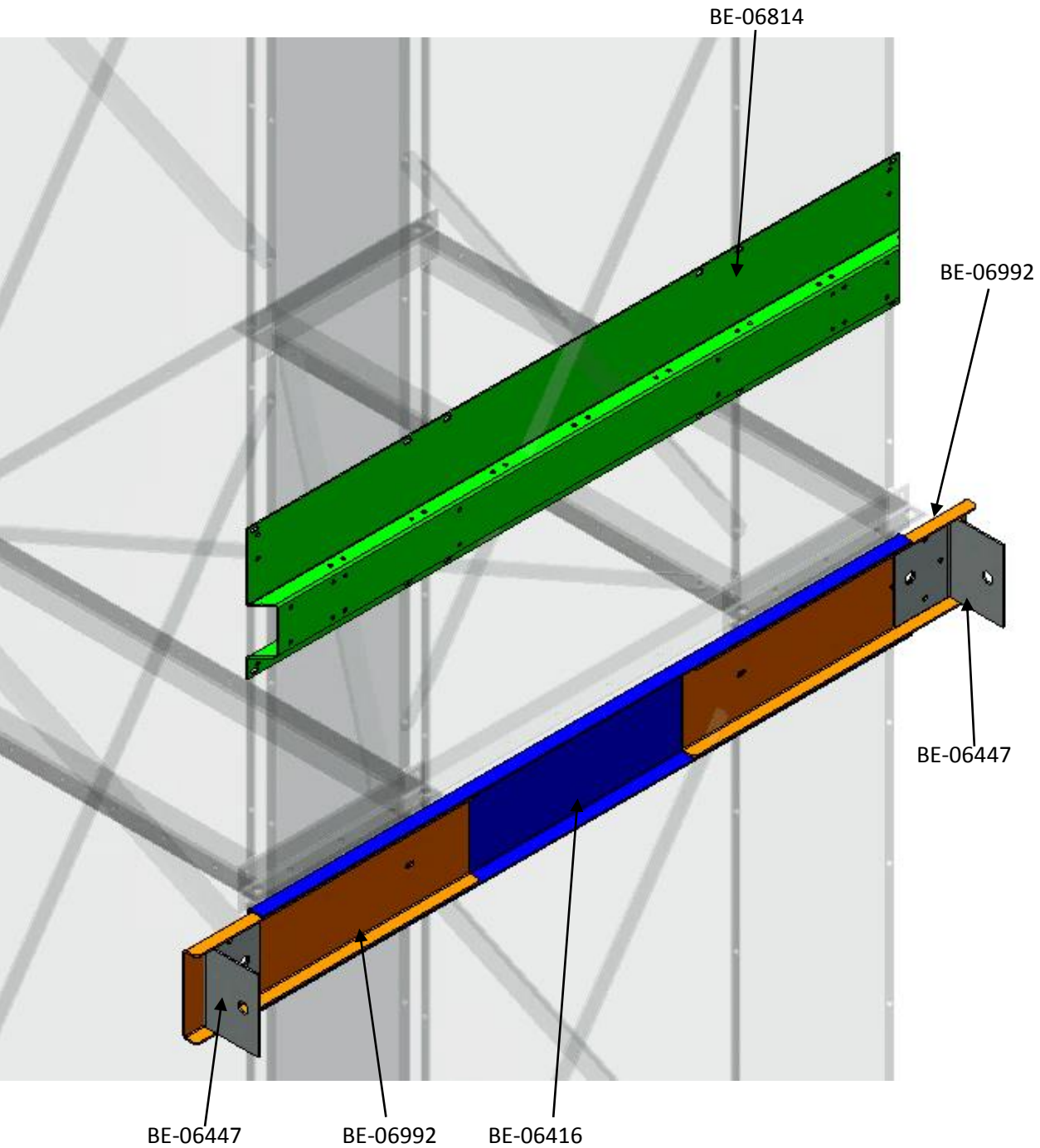

The rest platforms can be located where you wish vertically on the trunks depending on your desire. Below will show the spacing between the toeboard channel and the anchor channel.

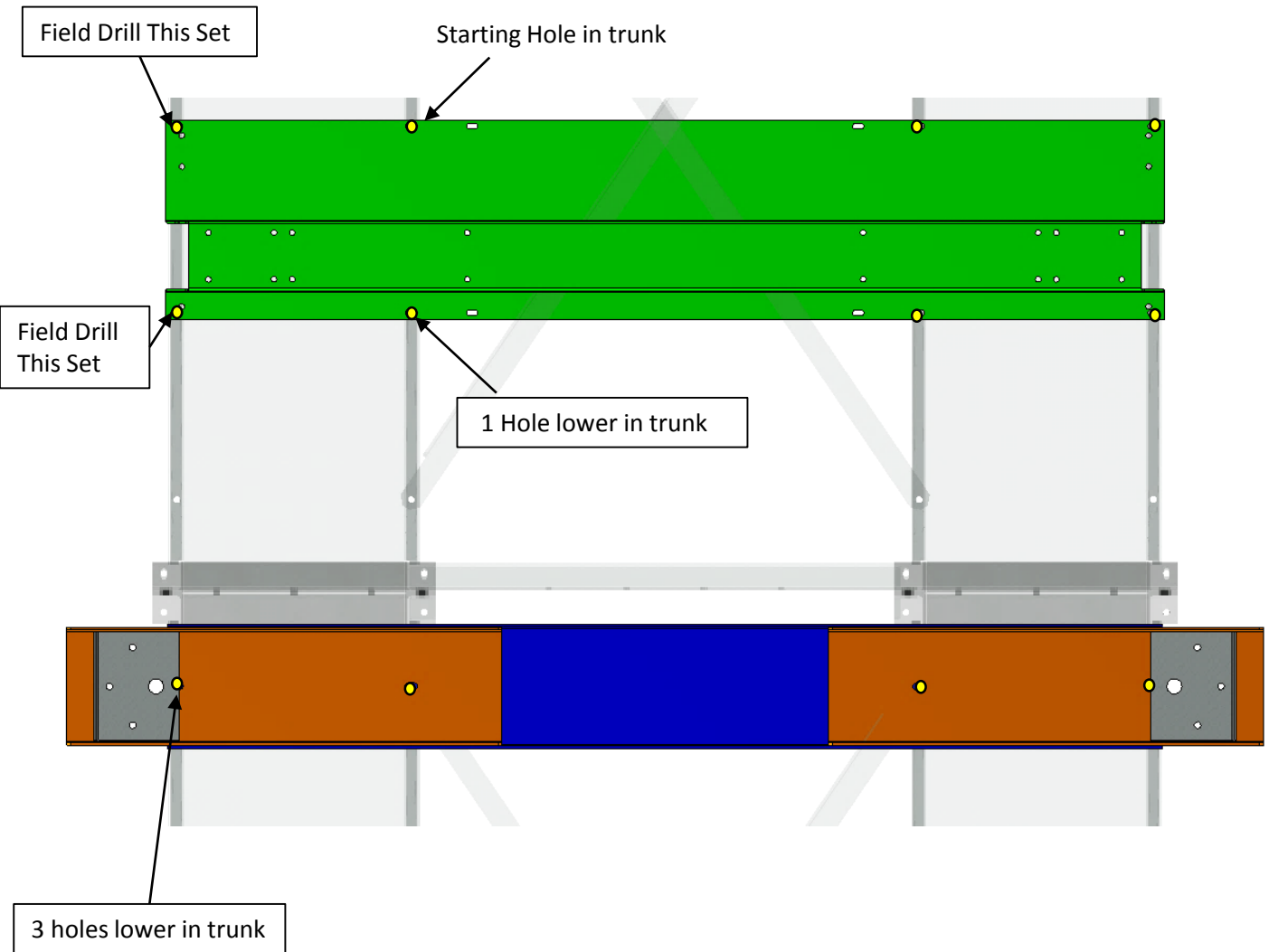

Next install the toe board channels and kick braces as shown

Use 5/16" x 3/4" Bolt and Nuts

Use 7/8" Bolt, 7/8" Lock Washer, 1" Washer, and 7/8" Hex Nut for kick brace

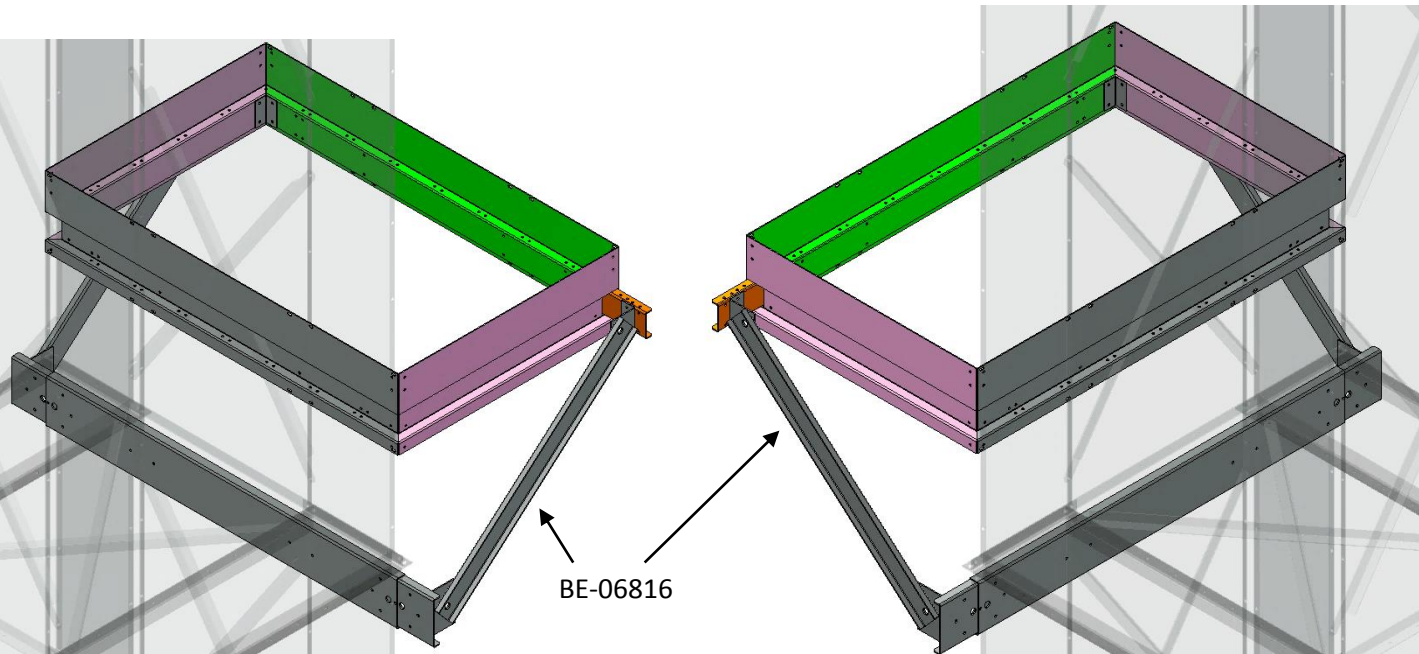
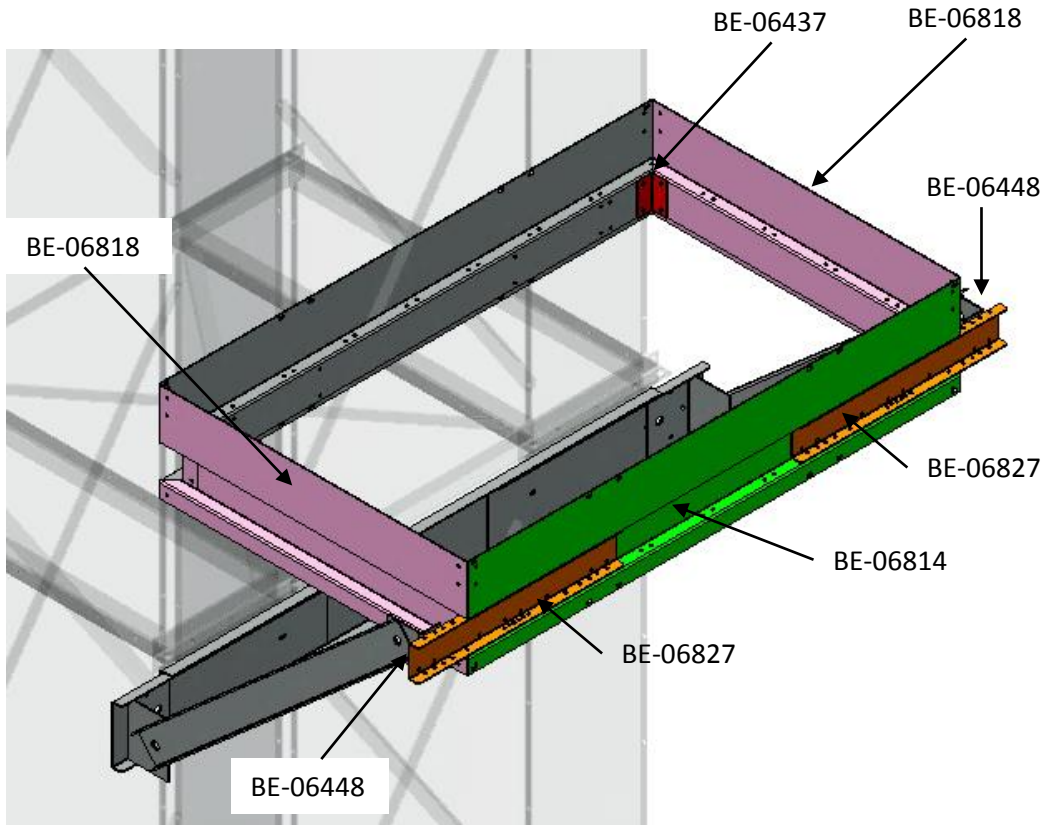

Install floor planks and toeboard, the toe board will mount to the side of the floor plank.
Use 5/16" x 3/45" Truss Bolt and Nuts

FPLANK-16-040
40" LONG

BE-06817

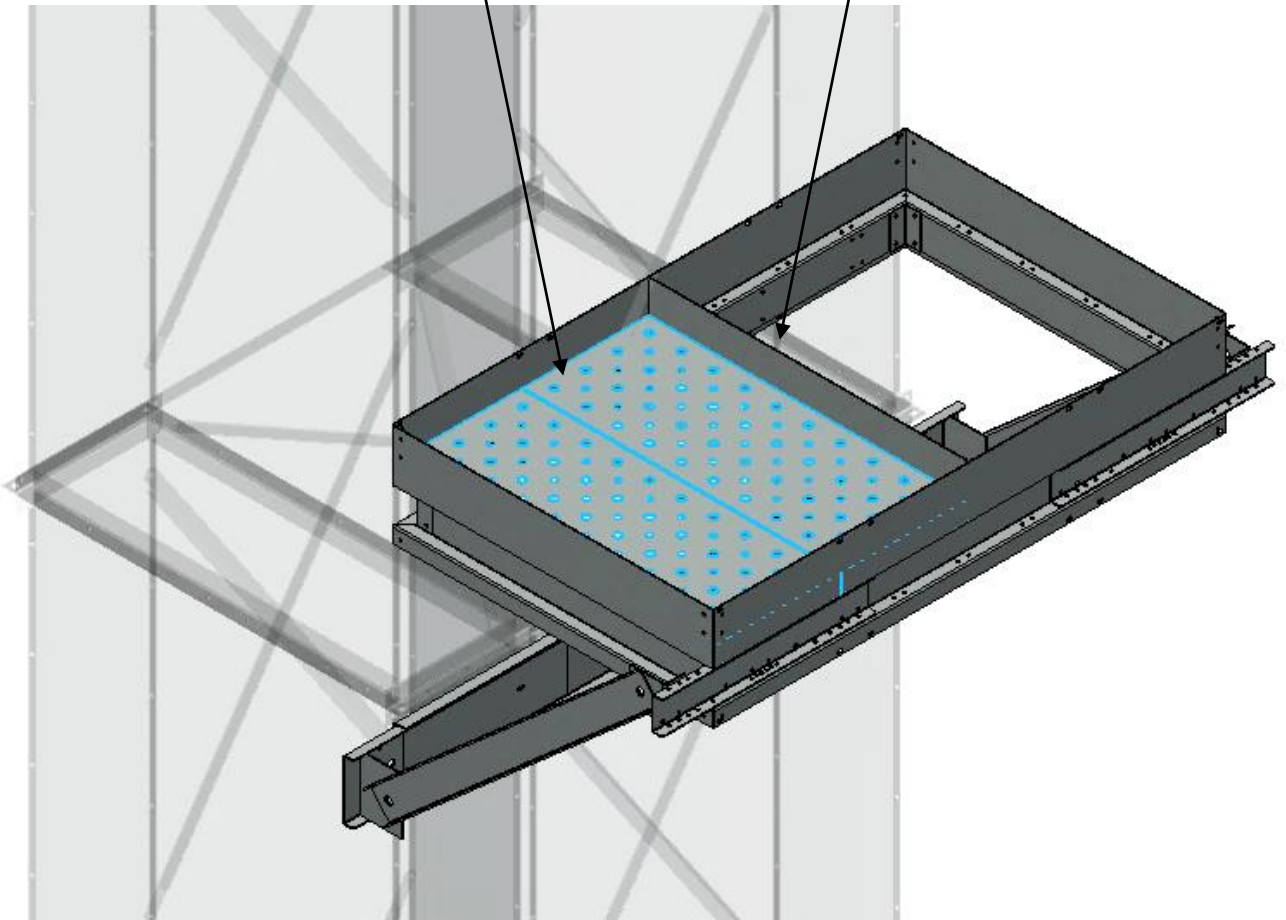

Fasten Floor
Planks Together

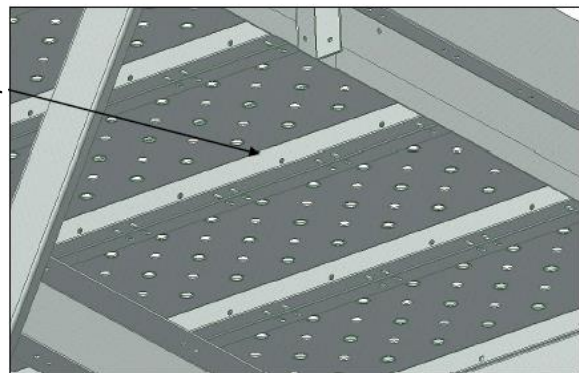

Install rail post to the corners of the platform.
Use 5/16" x 3/4" Bolt and Nuts

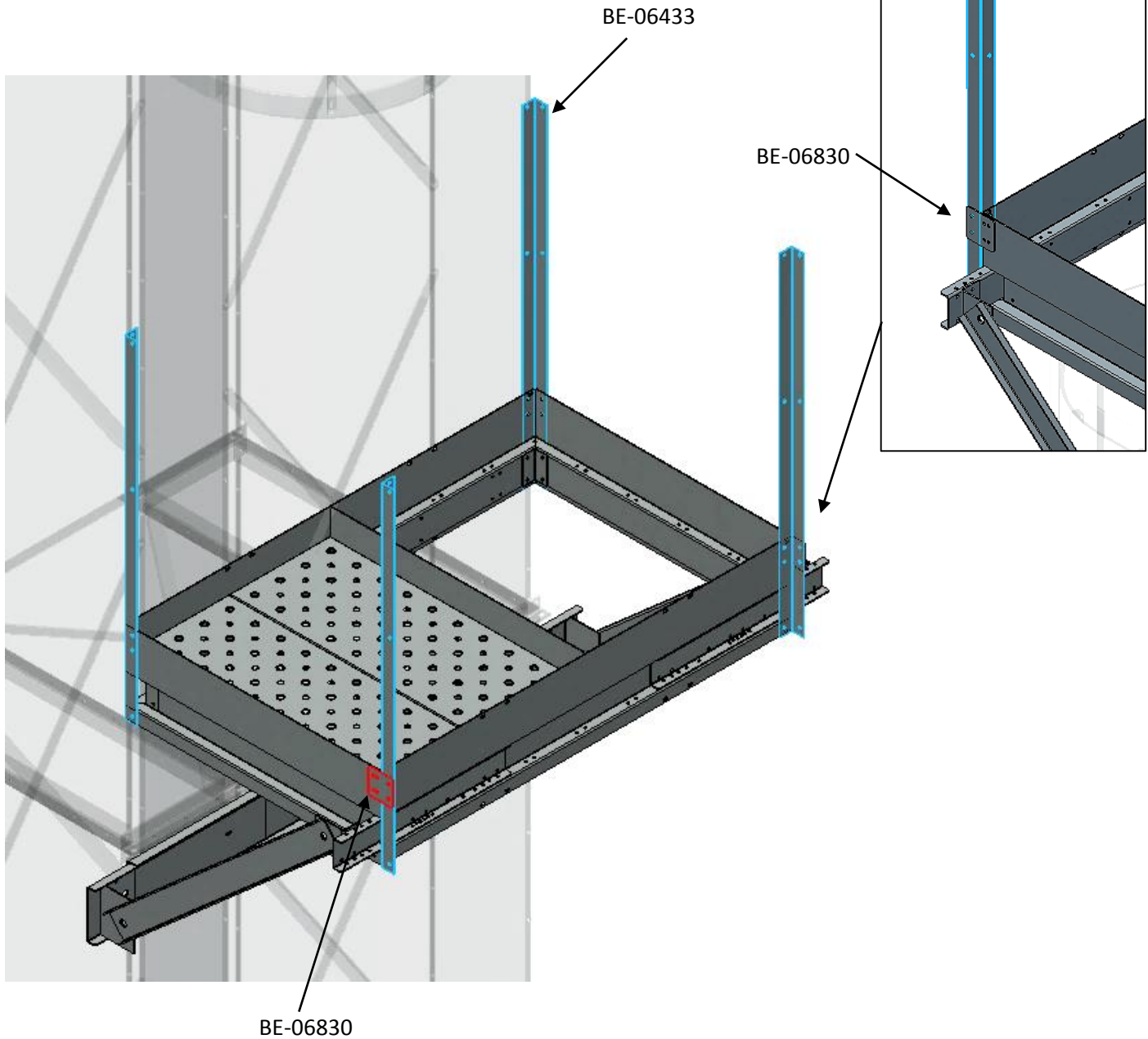

Install hand rails to the rail post as shown below
Use 5/16" x 3/4" Bolt and Nuts

